

T. 5S., R. 3W., W.M.

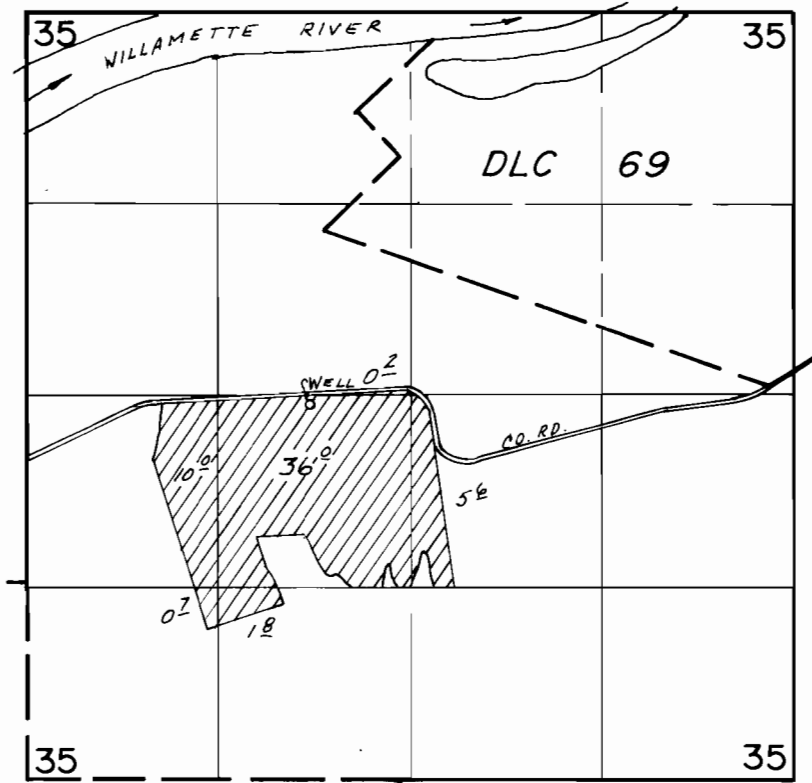

WELL LOC: 60'S. & 1940'E. FROM W. 1/4 COR. SEC. 35

FINAL PROOF SURVEY
UNDER

Application No. G-6959 Permit No. G-6471.....
IN NAME OF

DAVIS STREET INVESTMENT COMPANY

Surveyed OCT. 4, 1983, by L.M. TOLL.....