

T.3S., R.8W., W.M.

(SECTION 17)

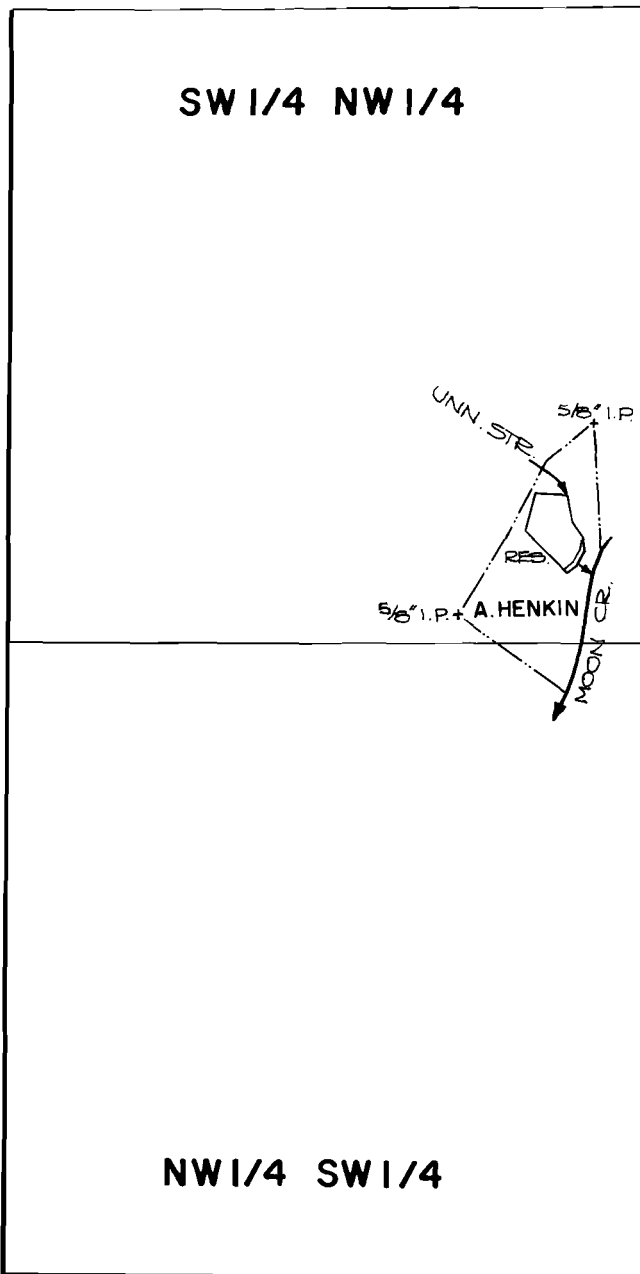

DAM LOCATION: 170 FT. N. AND 1190 FT. E. FROM THE W. 1/4 CORNER OF SECTION 17.

FINAL PROOF SURVEY

UNDER



SCALE: 1" = 400'

R-52678 R-6445
Application No. 52679... Permit No. 40439.....

IN NAME OF

.....ALBERT HENKIN.....

Surveyed SEPT. 10., 1984., by P. Pagan.....