

T. 5 S., R. 3 W., WM.

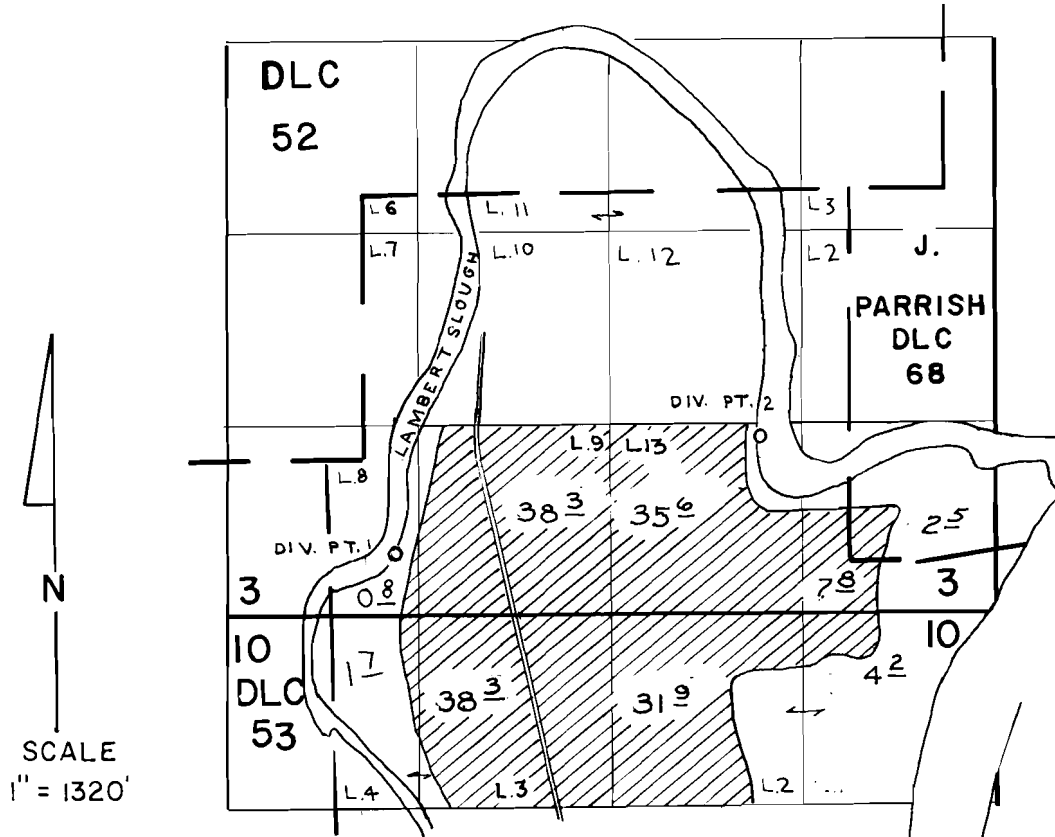

DIV. PT. LOC. (1) 650' S. & 310' E.
 (2) 150' N. & 2730' E
 MEASURED FROM NE COR. DLC 53

FINAL PROOF SURVEY UNDER

Application No. 53956 Permit No. 40706
 IN NAME OF

E. D. GRASSMAN FARMS, INC.

Surveyed APR. 27 1984, by P. PAGTER