

P. 41214 57510
P. 41215 57511

T. 9 & 10 S. R. 20 E. W.M.

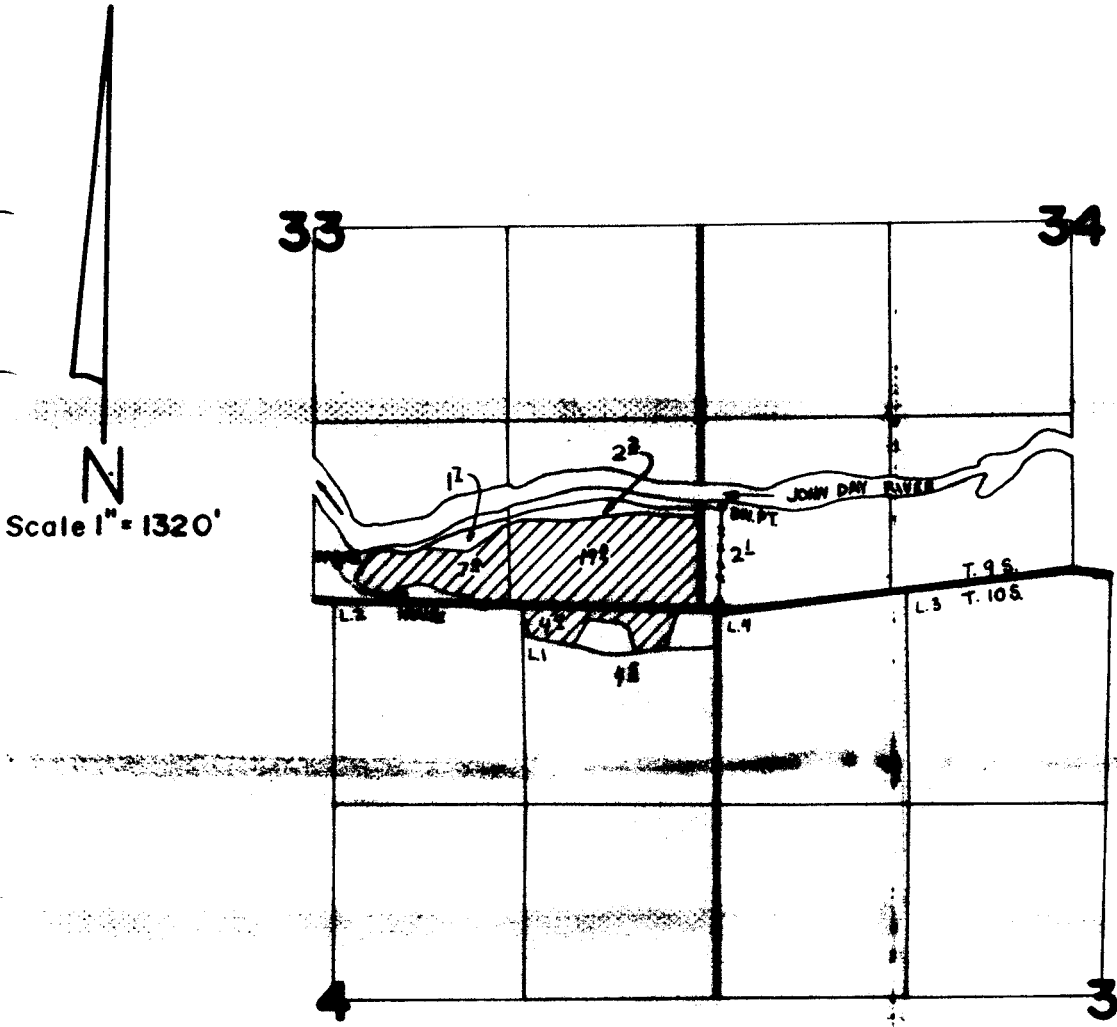

Scale 1" = 1320'

DIV. PT. LOC. 700' N. & 700' E. FROM S.W. COR. SEC. 34
SPRING LOC. 220' N. & 70' E. FROM N. 1/4 COR. SEC. 34

FINAL PROOF SURVEY UNDER

55001 41214
Application No. ~~55002~~ Permit No. ~~41215~~.....
IN NAME OF

KENNETH A. BOND

Surveyed April 21, 1986, by V. Church.....