

T.38S., R.3W., W.M.

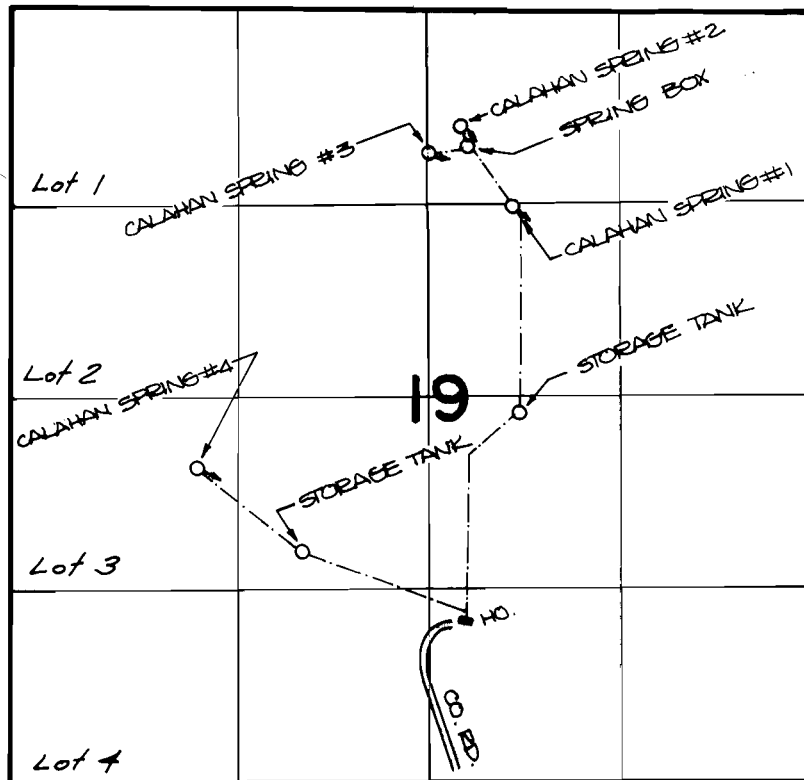

CALAHAN SPRING LOCATIONS: #1: 1200' N. AND 560' E;
 #2: 1035' N. AND 90' E; #3: 1040' N. AND 10' W;
 #4: 540' S. AND 1600' W; ALL FROM THE CENTER OF SECTION 19.

FINAL PROOF SURVEY UNDER

Application No. **56758** Permit No. **42587**
55235 **41418**
 IN NAME OF

DAVID P. AND/OR JANICE J. CALAHAN AND/OR SURVIVORS

Surveyed **JULY 13, 1983**, by **B. JAMES**