

T.5S. R.4W. W.M. (SECTION 27)

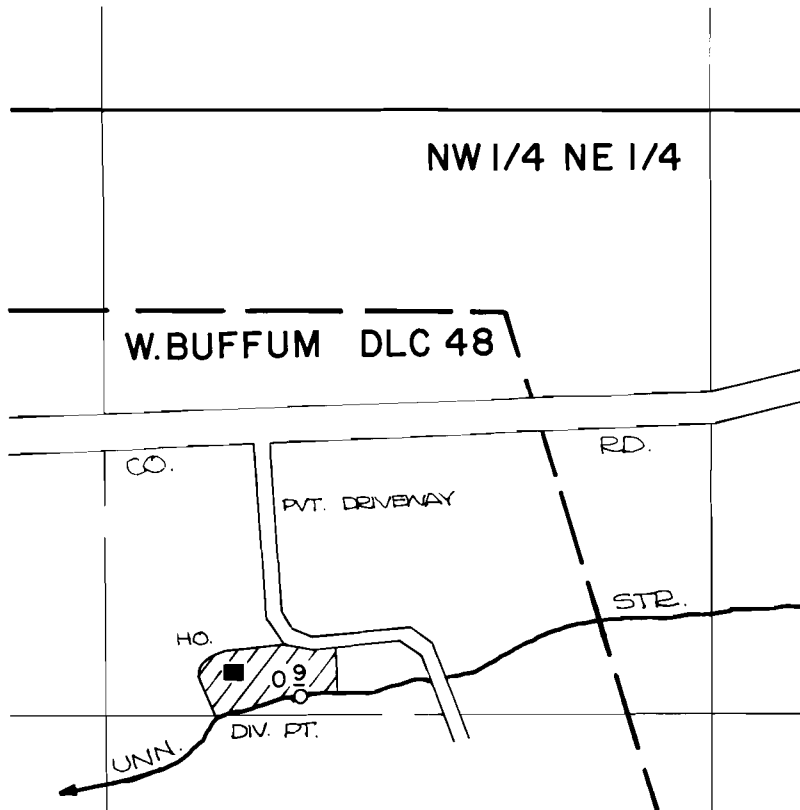

DIVERSION POINT IS LOCATED 930'S. AND 420' W. FROM THE N.E. CORNER OF THE W. BUFFUM DLC # 48.

SCALE: 1" = 400'

FINAL PROOF SURVEY
UNDER

Application No. **55654**.. Permit No. **41692**.....
IN NAME OF

MARIE A. BENJAMIN

Surveyed **OCT. 6**... **1983**., by **P. Foster**.....