

T.38S., R.3 & 4W., W.M.

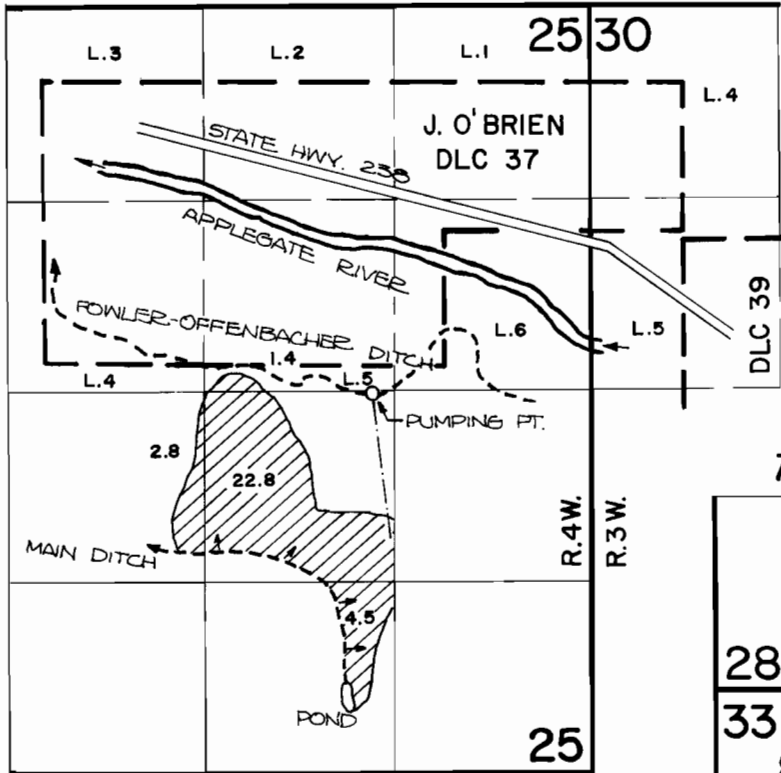

DIV. PT. IS LOCATED 40' N. AND 1610' E. FROM THE S.W. CORNER OF SECTION 28, T.38S., R.3W., W.M.

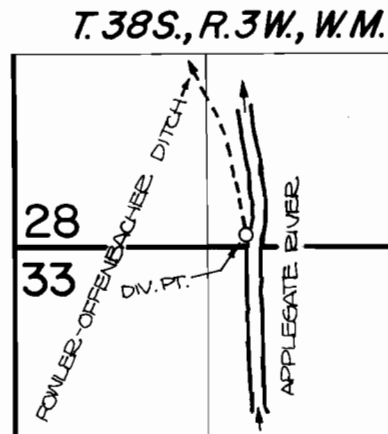

FINAL PROOF SURVEY UNDER

Application No. 62061 50272... Permit No. 46020 37905.....
IN NAME OF

APPLEGATE BRANGUS RANCH

OCT. 31 1983
Surveyed JULY.20. 1983., by ..B.....JAMES...