

T. 29S., R. 4W., W.M.

SEC. 23

SWNW

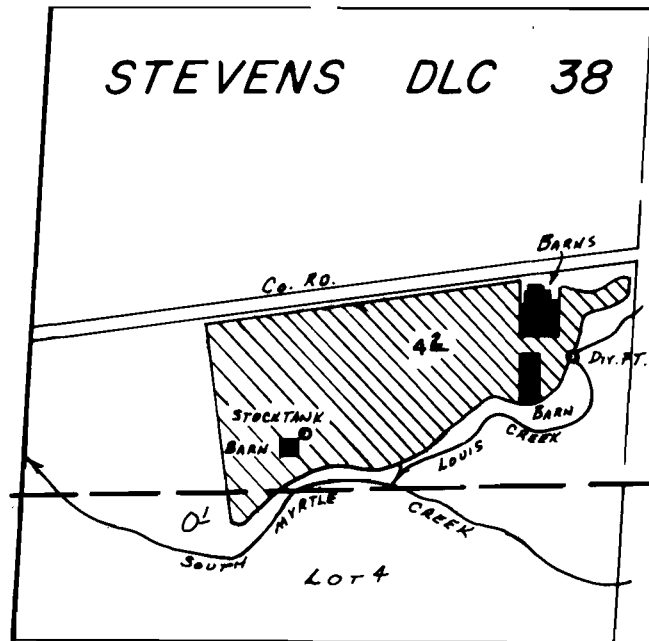

DIV. PT. LOC.: 600' N. & 1165' E. FROM W. 1/4 COR. SEC. 23.  
STOCK USE IN BARNS & PORTABLE FACILITIES THROUGHOUT  
IRRIGATED AREA ON WEST END.

SCALE: 1" = 400'

**FINAL PROOF SURVEY**  
UNDER

53352                      39583  
Application No. 59002    Permit No. 44491.....  
IN NAME OF

RAYFORD L., Jr. & MILDRED L. ATKESON

AUG. 26 87    J. M. SCHMORDE  
Surveyed MAR. 14 1979, by J. S. DONALDSON  
JUNE 23 1980

*BWB*