

T.4S., R.5W., W.M.

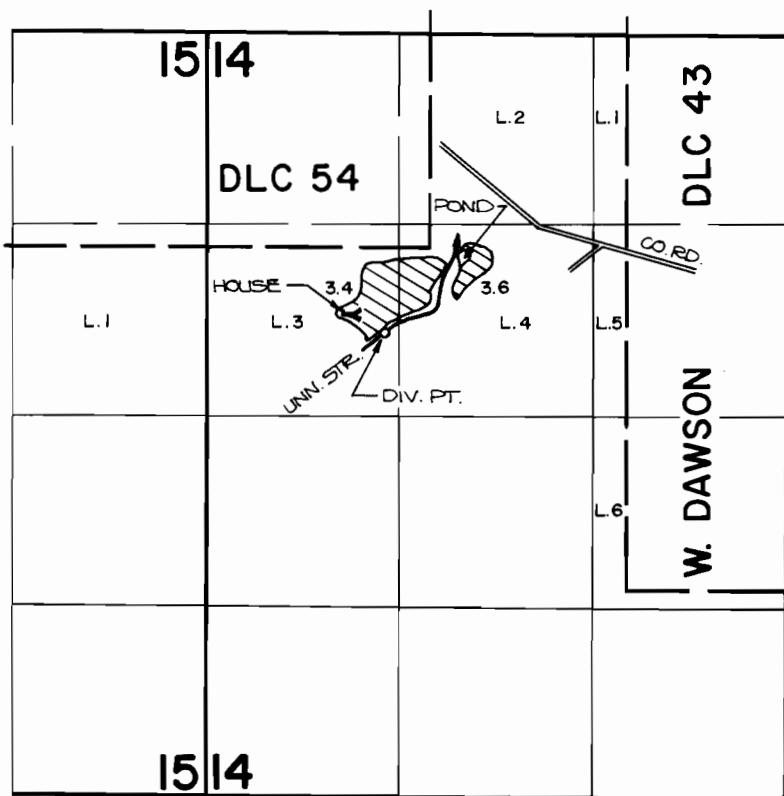

DIV. PT. LOCATION: 2060 FT. S. AND 1210 FT. E. FROM THE N.W. CORNER OF SECTION 14.



SCALE: 4" = 1 MILE

FINAL PROOF SURVEY UNDER

Application No. 55155... Permit No. 41458.....
IN NAME OF

HARRY B. CURE

Surveyed SEPT. 19, 1984, by P. Pagten