

T. 5&6S., R. 6W., W.M.

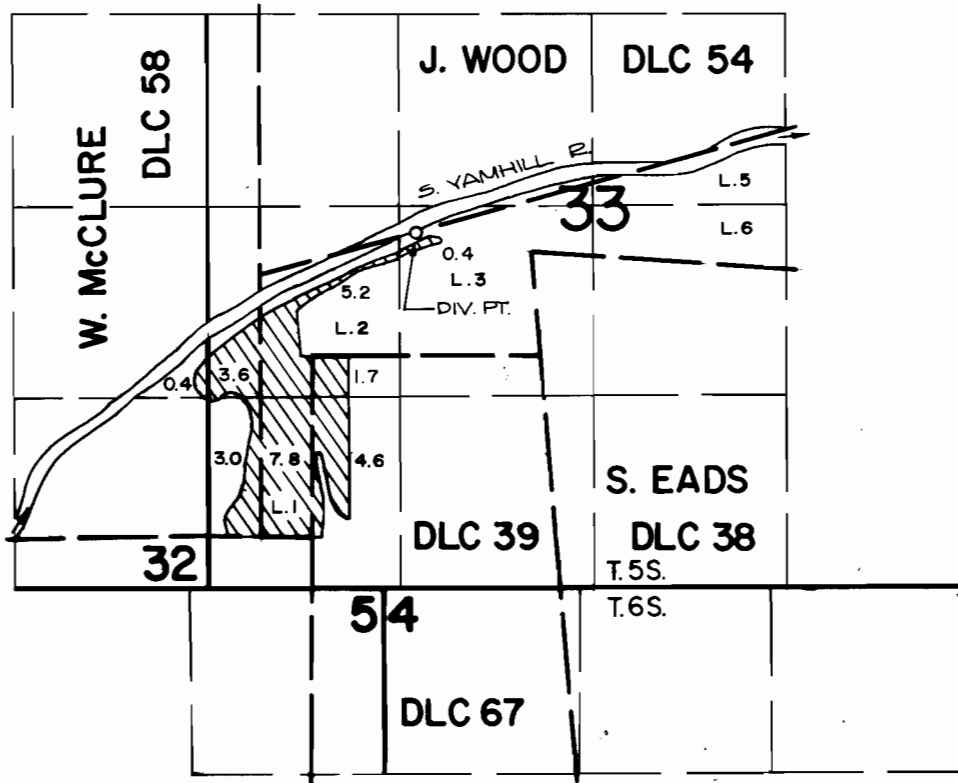

DIV. PT. LOCATION: 175 FT. S. AND 100 FT. E. FROM THE N.E. CORNER OF THE NW 1/4 SW 1/4 OF SECTION 33.

FINAL PROOF SURVEY UNDER

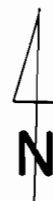

SCALE: 4" = 1 MILE

Application No. 55104 Permit No. 41385
IN NAME OF

WILLIAM & FRANCINE DRABKIN

Surveyed OCT. 30, 1984, by P. Patten