

T.5S., R.2W., W.M.

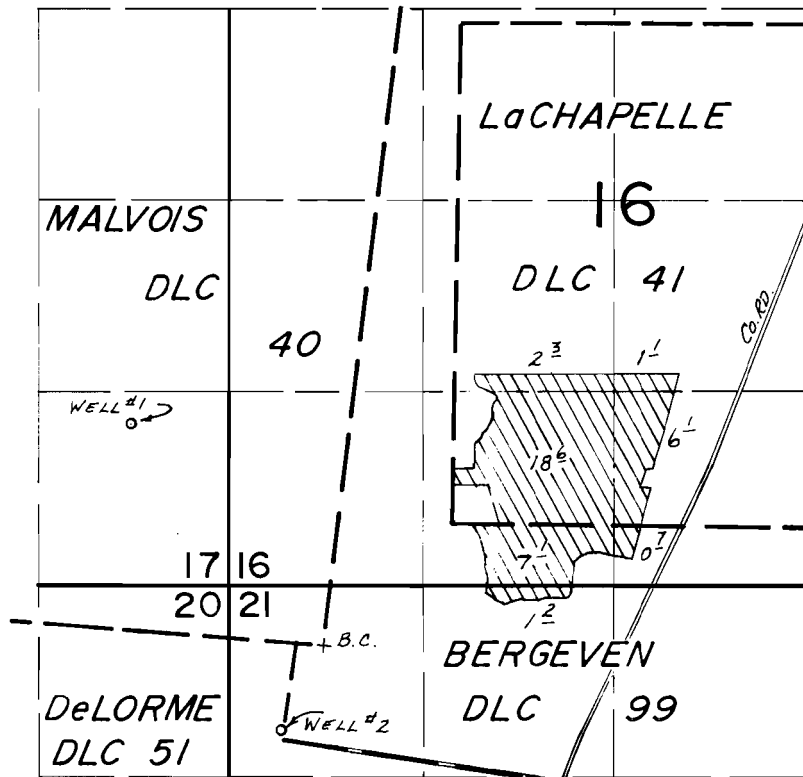

WELLS LOC: #1- 1520' N. & 1350' W., #2- 570' S. & 300' W., BOTH FROM SE COR. MALVOIS DLC 40.

FINAL PROOF SURVEY
UNDER

Application No. ~~G-8047~~ Permit No. G-7672.....
IN NAME OF

.....CYRIL & ANITA FERSCHWEILER.....

Surveyed OCT. 3..... 19.83, by L.M.TOLL.....