

# T. 34S., R. 6W., W.M.

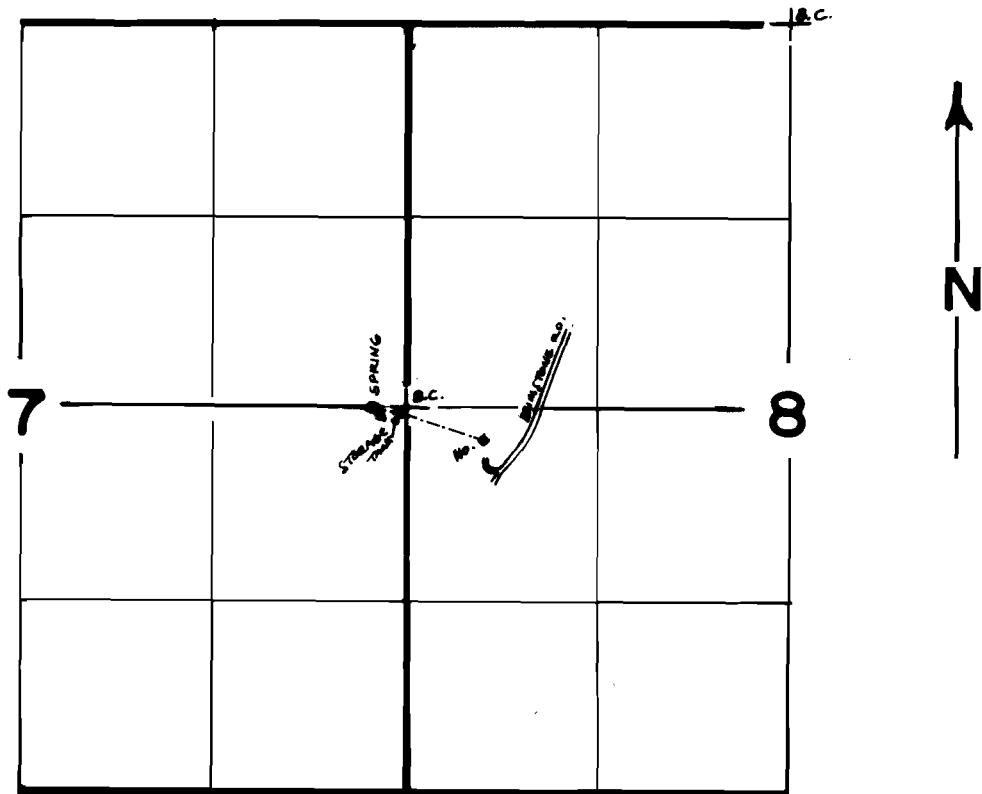

SPRING: 225' W. & 0' N. OF W. 1/4 CORNER SEC. 8

SCALE 1" = 1320"

## FINAL PROOF SURVEY UNDER

Application No. 55715... Permit No. 41730.....  
IN NAME OF

NORRIS HORN.....

Surveyed SEPT. 6. 1924., by J. R. WOODRUFF