

T. 4 S., R. 3 W. WM.

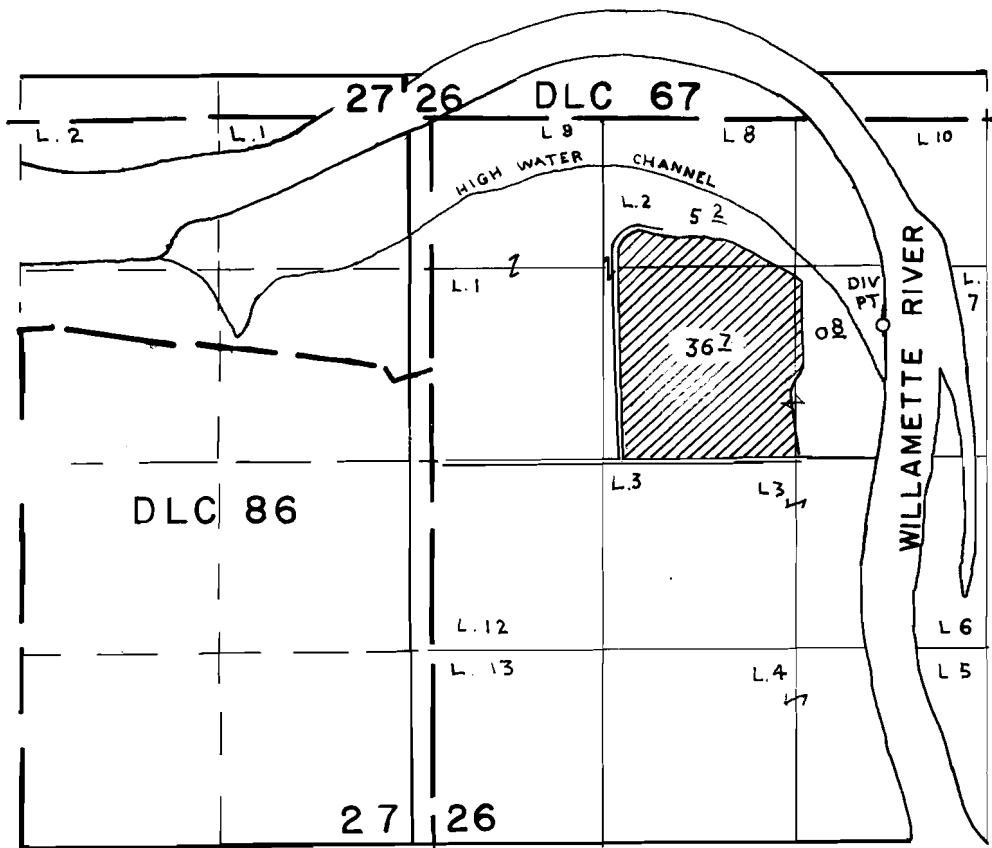

DIV. PT. LOC. 3550' N. & 3250' E. OF SW COR. SEC 26

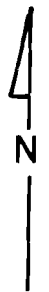

SCALE
1" = 1320'

FINAL PROOF SURVEY
UNDER

Application No. 55301 Permit No. 41636
IN NAME OF

BARRY HOUSE

Surveyed MAY 16, 1984, by P. PAGTER