

T. 4 S., R. 3 W., W. M.

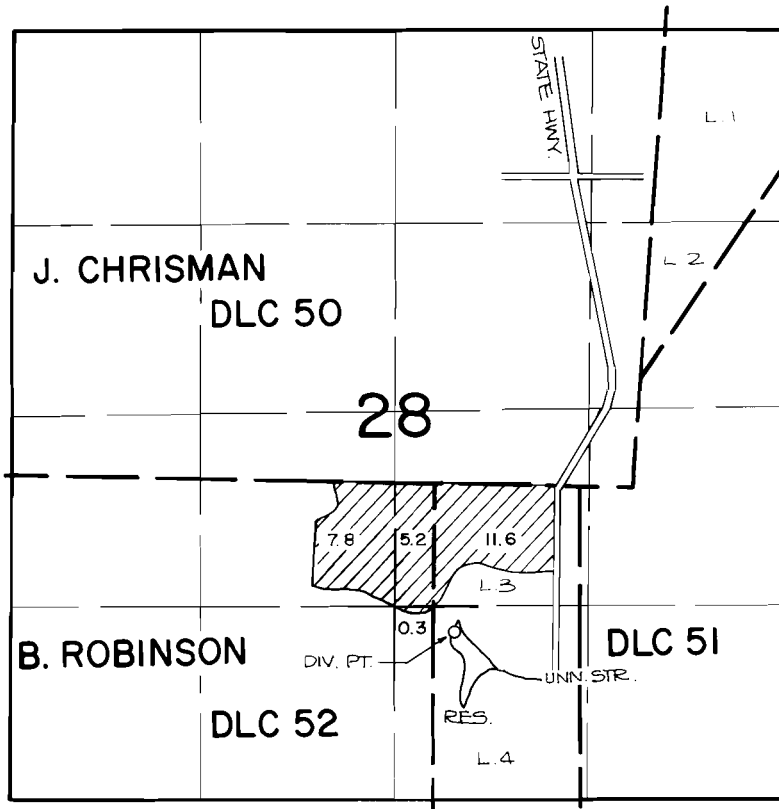

DIV. PT. LOCATION: 17.5 CH. N. AND 6.2 CH. E. FROM THE
S¹/₄ CORNER OF SECTION 28.

N

SCALE: 4" = 1 MILE

FINAL PROOF SURVEY
UNDER

Application No. 55378.. Permit No. 41502.....
IN NAME OF

.....**CARL F. RUTSCHMAN**.....

Surveyed MAY 15, 1984, by *P. Pagter*.....