

# T. 37S., R. 3W., W.M.

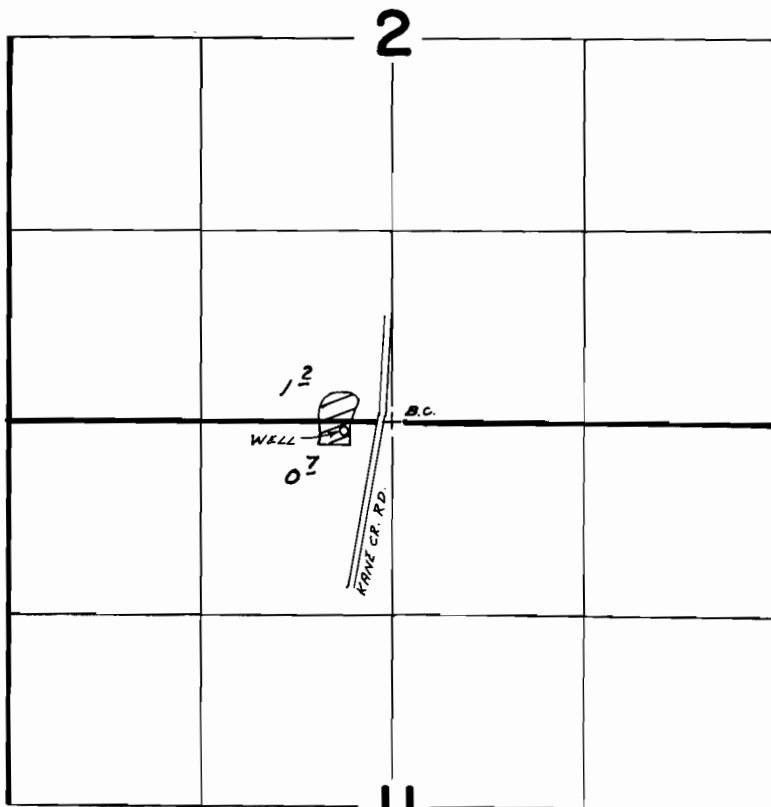

WELL LOCATED: 60'S & 300' W FROM N 1/4 CORNER, SEC 11

Scale 1"=1320'

## FINAL PROOF SURVEY

UNDER

Application No. G-7507 Permit No. G-6986...  
IN NAME OF

LESTER B. and or WAUNEVIA WAKEMAN

Surveyed July 21, 1987, by B.S. JAMES.....