

T. 4 S., R. 9 & 10 W., W.M.

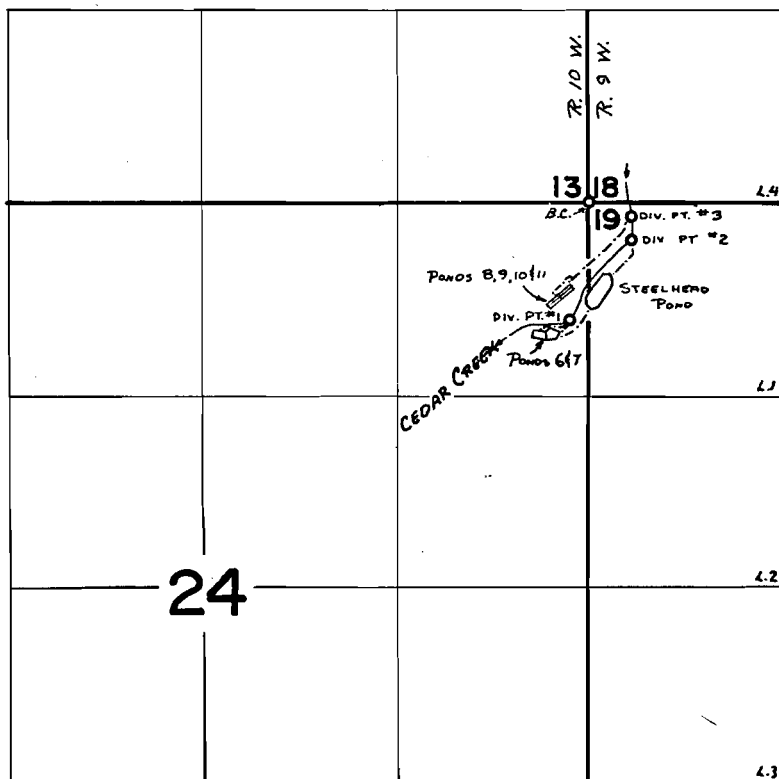

Loc: Div. Pt. #1 - 800'S AND 130' W FROM NE COR. SEC. 24
 Div. Pt. #2 - 250'S AND 300' E FROM NW COR. SEC. 19
 Div. Pt. #3 - 100'S AND 300' E FROM NW COR. SEC. 19

FINAL PROOF SURVEY

UNDER
 Transfer No. 2450 ~~8~~ 2451

45919	34307
R-45949	R-5464
R-47573	R-5731
47574	35619
R-47575	R-5732
Application No. 47576	Permit No. 35620

IN NAME OF

OREGON STATE GAME COMMISSION

Surveyed JUNE 25 1974, by L. TOLL

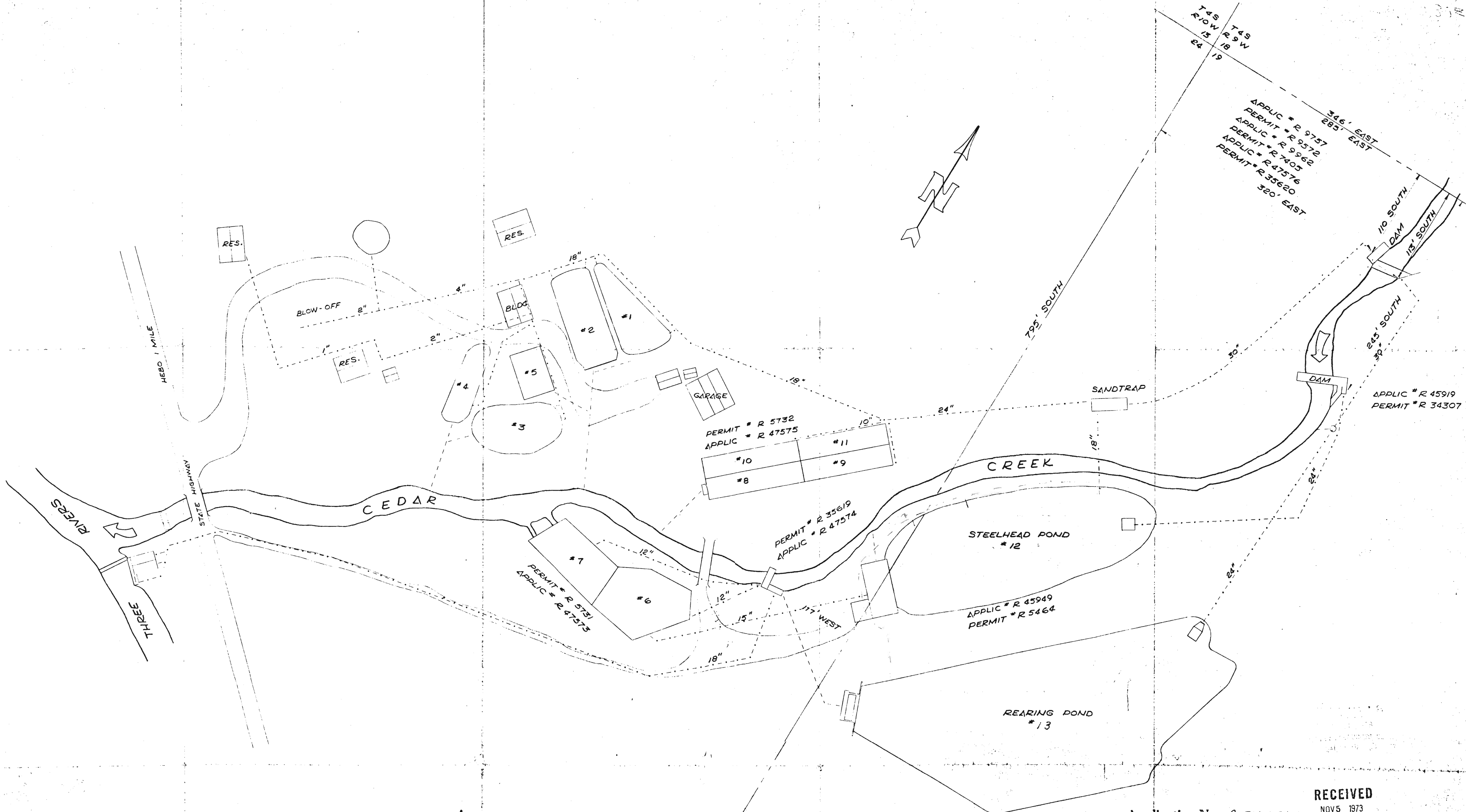

T4S R10W E4
 T4S R9W E4
 346' EAST
 285' EAST
 APPLIC # R 9757
 PERMIT # R 9572
 APPLIC # R 9962
 PERMIT # R 7403
 APPLIC # R 47576
 PERMIT # R 35620
 320' EAST

APPLIC # R 45919
 PERMIT # R 34307

PERMIT # R 5732
 APPLIC # R 47575
 #10 #11
 #8 #9

PERMIT # R 35619
 APPLIC # R 47574

APPLIC # R 45949
 PERMIT # R 5464

PERMIT # R 5731
 APPLIC # R 47573

Application No. R-50645 & 57750
 Permit No. R 7776 4384

RECEIVED
 NOV 5 1973

STATE ENGINEER
 SALEM, OREGON

LEGEND:
 --- SUPPLY PIPE LINE
 - - - DRAIN PIPE LINE

OREGON STATE GAME COMMISSION
 PORTLAND, OREGON
**CEDAR CREEK HATCHERY
 PIPELINES AND WATER RIGHTS**

DESIGNED BY	APPROVED BY CHIEF ENGINEER	DATE	REVISION BY
DRAWN OCT 73 PJB	APPROVED BY DIRECTOR		
CHECKED	SHEET 1 OF 1	DRAWING NO.	
SCALE 1" = 50'-0"	SHEETS	1-47	