

# T. 4 S., R. 9 & 10 W., W.M.

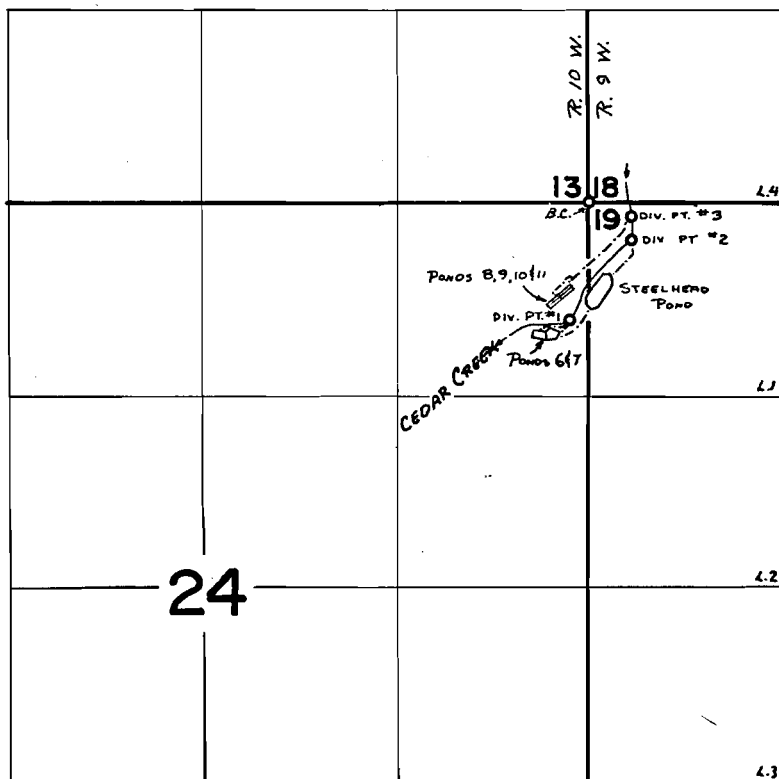

Loc: Div. Pt. #1 - 800'S AND 130' W FROM NE COR. SEC. 24  
 Div. Pt. #2 - 250'S AND 300' E FROM NW COR. SEC. 19  
 Div. Pt. #3 - 100'S AND 300' E FROM NW COR. SEC. 19

## FINAL PROOF SURVEY

UNDER  
 Transfer No. 2450 & 2451

45919	34307
R-45949	R-5464
R-47573	R-5731
47574	35619
R-47575	R-5732
Application No. <u>47576</u>	Permit No. <u>35620</u>

IN NAME OF

OREGON STATE GAME COMMISSION

Surveyed JUNE 25 1974, by L. TOLL

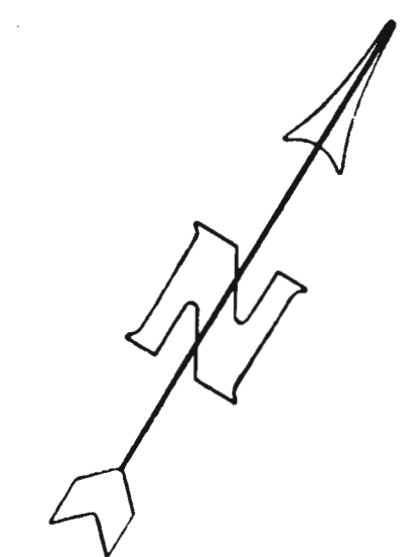
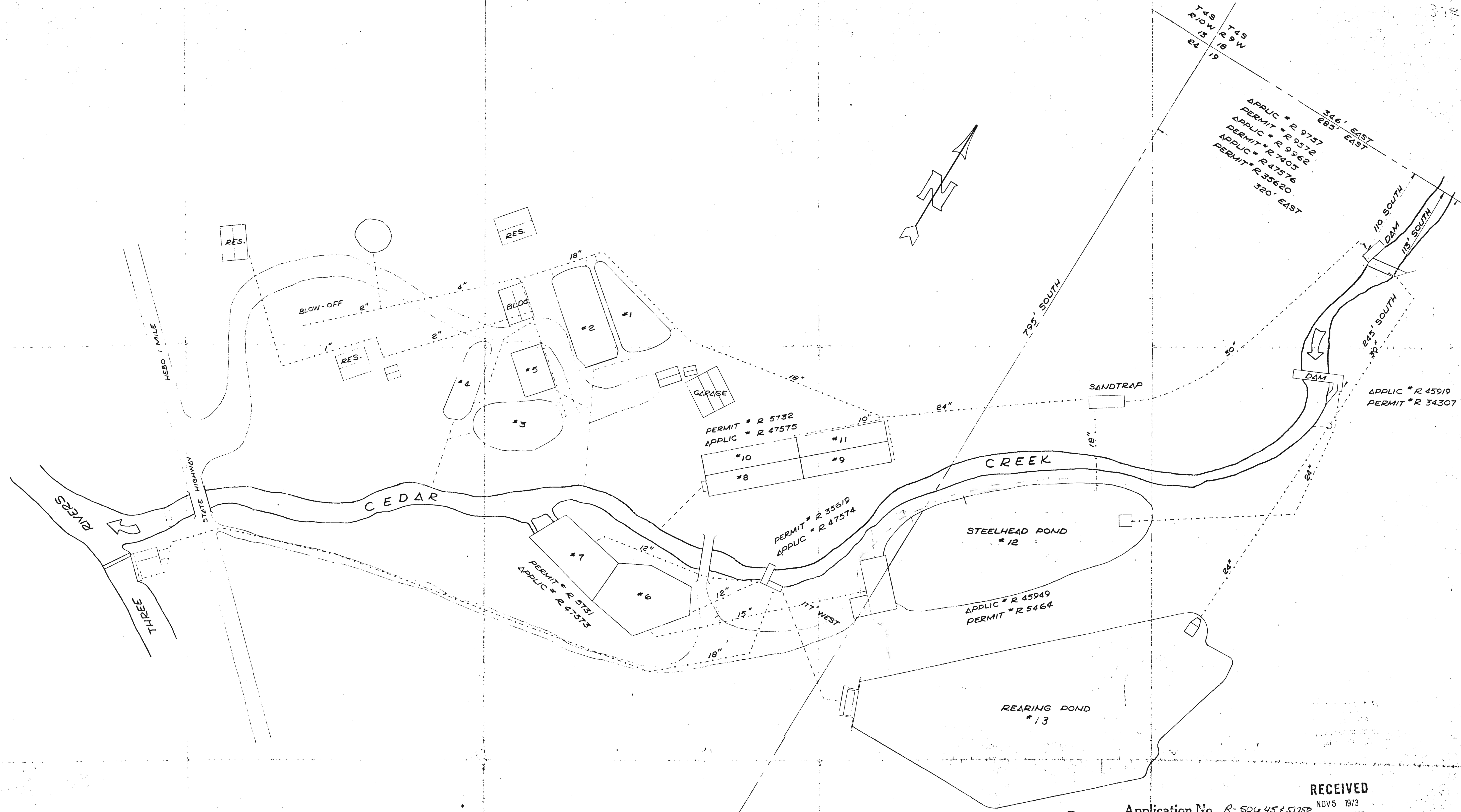

T4S  
R10W  
E4  
15  
18  
19

T4S  
R9W  
E4  
18  
19

346' EAST  
285' EAST

APPLIC # R 9757  
PERMIT # R 9572  
APPLIC # R 9962  
PERMIT # R 7403  
APPLIC # R 47576  
PERMIT # R 35620  
320' EAST

APPLIC # R 45919  
PERMIT # R 34307

PERMIT # R 5732  
APPLIC # R 47575

PERMIT # R 35619  
APPLIC # R 47574

APPLIC # R 45949  
PERMIT # R 5464

PERMIT # R 5731  
APPLIC # R 47573

Application No. R-50645 & 57750  
Permit No. R 7776 4384

RECEIVED  
NOV 5 1973

STATE ENGINEER  
SALEM, OREGON

LEGEND:  
- - - SUPPLY PIPE LINE  
- - - DRAIN PIPE LINE

OREGON STATE GAME COMMISSION  
PORTLAND, OREGON

**CEDAR CREEK HATCHERY  
PIPELINES AND WATER RIGHTS**

DESIGNED BY	APPROVED BY CHIEF ENGINEER	DATE	REVISION BY
DRAWN OCT 73 PJB	APPROVED BY DIRECTOR		
CHECKED	SHEET 1 OF 1	DRAWING NO.	
SCALE 1" = 50'-0"	SHEETS	1-47	