

T. 5 & 6 S., R. 5 W., W.M.

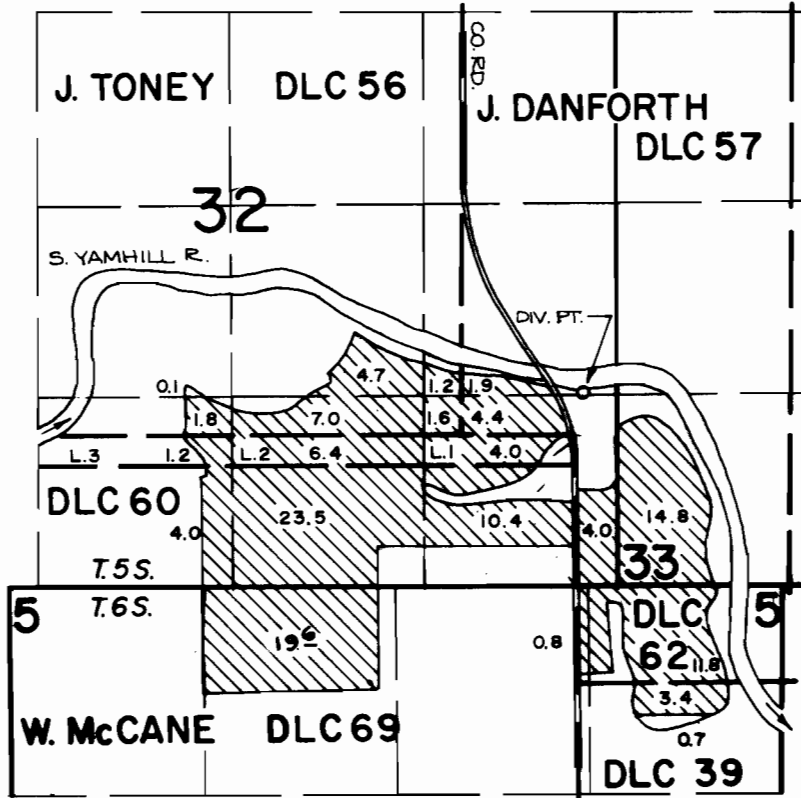

DIV. PT. LOCATION: 1340 FT. N. AND 220 FT. W. FROM THE S.E. CORNER OF SECTION 32.



SCALE: 4" = 1 MILE

FINAL PROOF SURVEY UNDER

Application No. 55106... Permit No. 41387.....

IN NAME OF

.....COYE M. MORRIS, JR.

Surveyed OCT. 1, 1984, by *P. Patten*.....