

T. 10 & 11 S., R. 1 W., W.M.

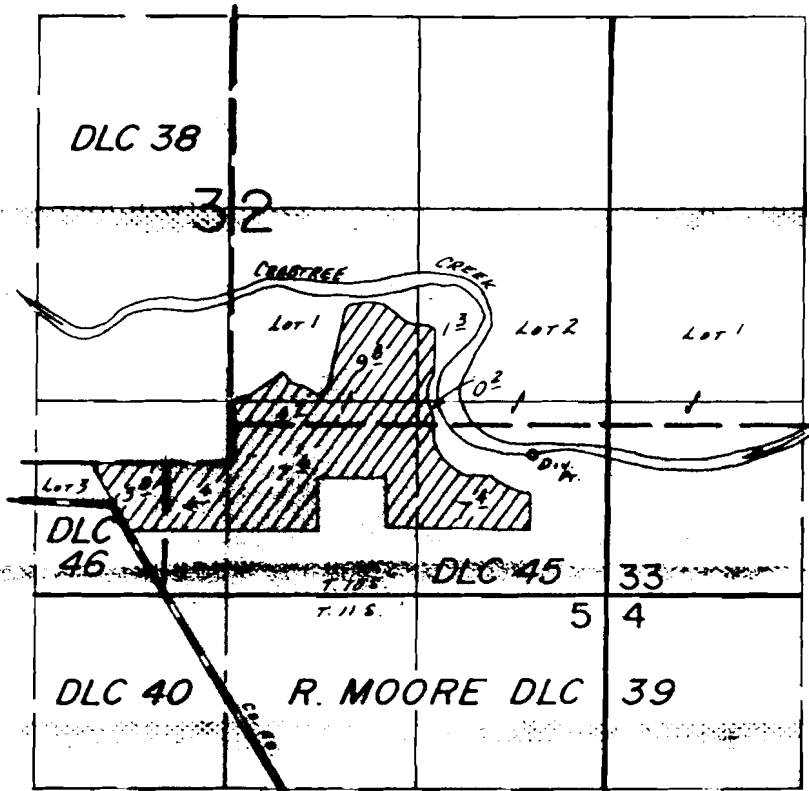

DIV. PT. LOC.: 950' N. & 510' W. FROM SE COR. SEC. 32.

SCALE: 1" = 1320'

FINAL PROOF SURVEY UNDER

Application No. 56976. Permit No. 42844
IN NAME OF

JAMES H. & DOROTHY FREEMAN

Surveyed Oct. 12, 1983, by M. CAHILL
Sept. 22, 1986, B.W. BISHOP