

T. 39 S., R. 3 W., W.M.

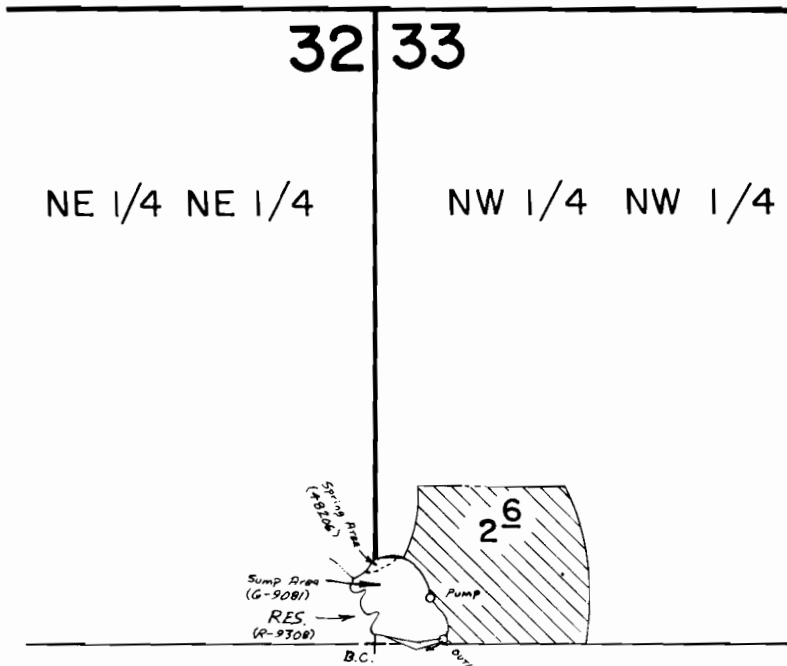

Spring area : 170' N & 10' E ; Sump Div. Pt. 90' N & 110' E ;
Reservoir 10' N & 190' E ; all from the SW cor.
of NW 1/4 NW 1/4 of Sec. 33.

Scale : 1" = 400'

FINAL PROOF SURVEY
UNDER

G-9863 G-9081
R-67696 R-9308
Application No. 67697... Permit No. 48206...
IN NAME OF

HAROLD C. & MARIANN N. DAVIDSON

Surveyed July 11, 1985, by B.S. JAMES.....
July 17, 1985.