

T. 6 S., R. 2 W., W.M.

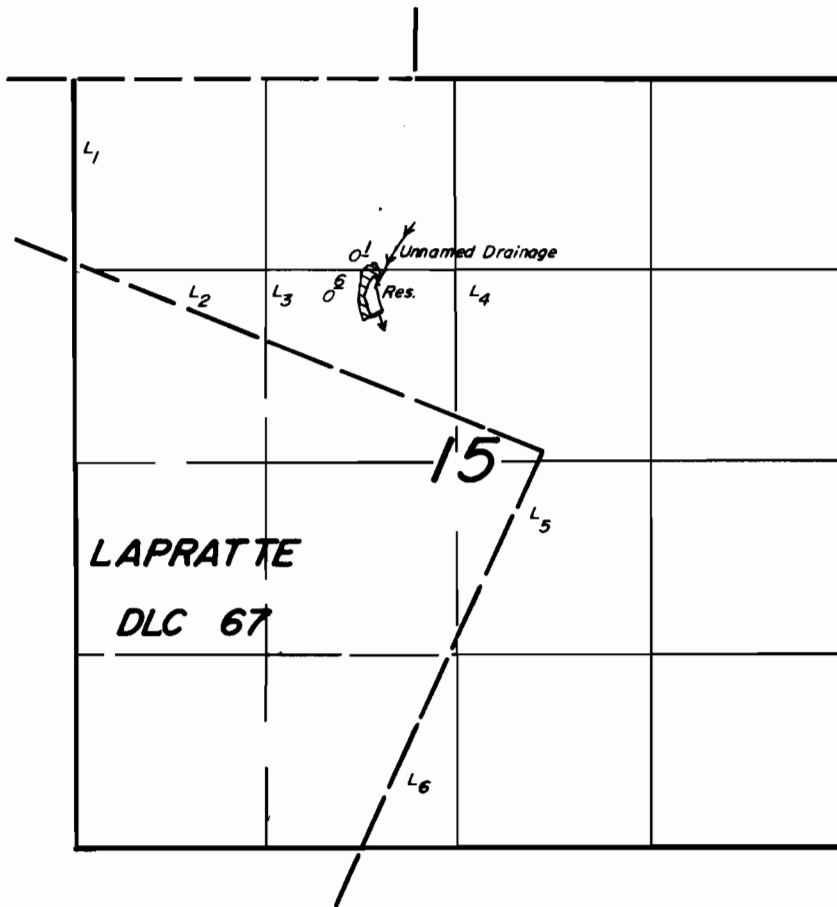

Div. Pt. Loc. : 1040' N. & 540' W. from C 1/4 Sec. 15.

Scale: 1" = 1320'

FINAL PROOF SURVEY

UNDER

R-59383 R-7970
 Application No. ~~59384~~.. Permit No. ~~44562~~.....
 IN NAME OF

.....**FRANK**.....**G**.....**HENNY**, Jr.....

Surveyed *May*...16.. 1984., by *Ben*..*Bishop*.....