

# T.5S., R.6W., W.M.

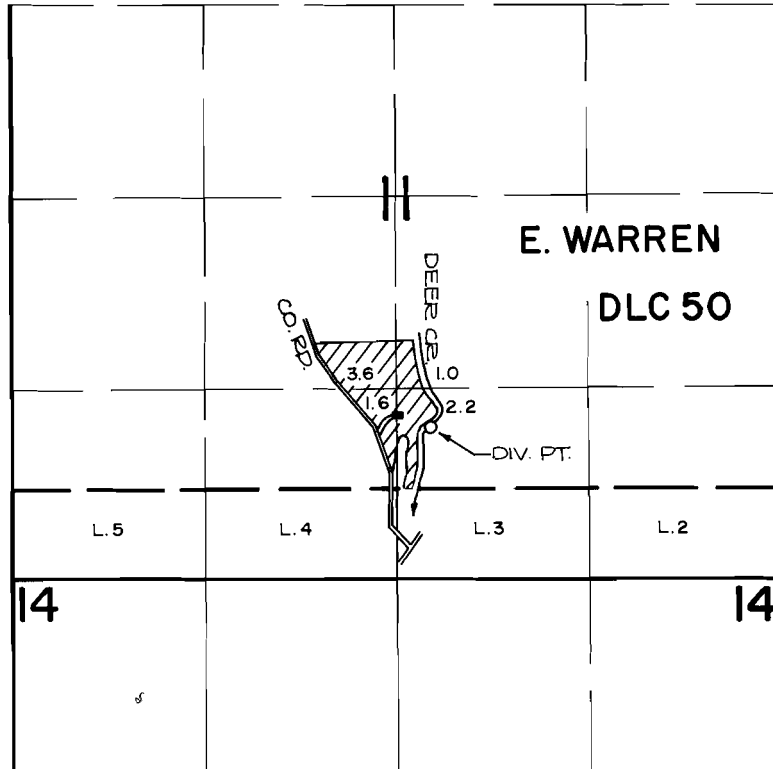

DIV. PT. LOCATION: 1500 FT. S. AND 230 FT. E. FROM THE CENTER OF SECTION 11.



SCALE: 4" = 1 MILE

## FINAL PROOF SURVEY UNDER

Application No. 53313... Permit No. 39557.....  
IN NAME OF

.....**LYDELL F. JONES**.....

Surveyed OCT. 3,..... 1984., by *P. Patten*.....