

T. 7S., R. 4W., W.M.

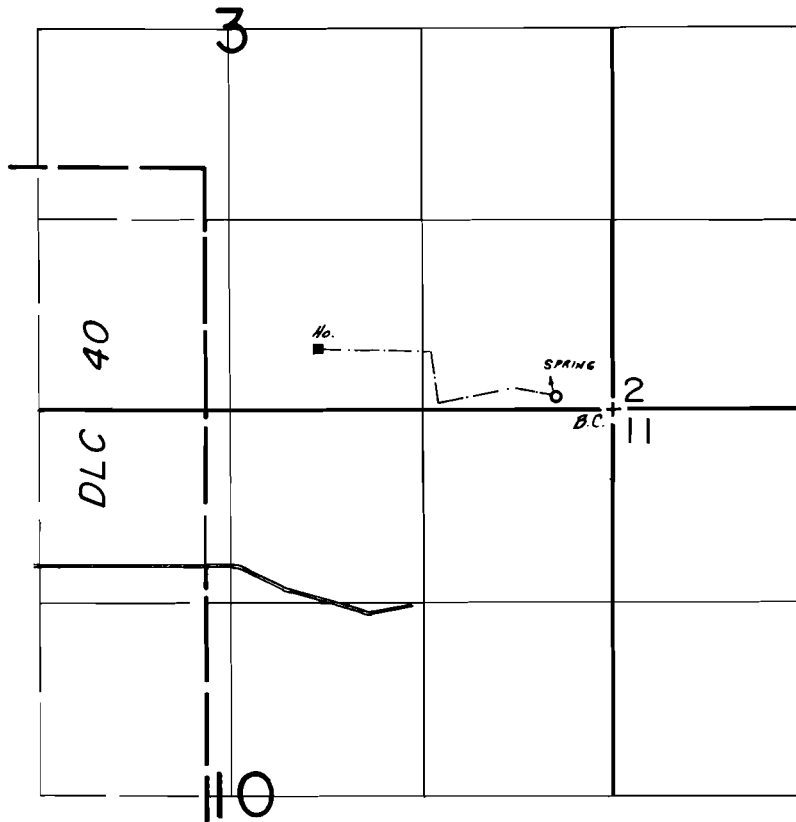

SPRING LOC.: 100' N. & 370' W. FROM SE COR. SEC. 3.

FINAL PROOF SURVEY
UNDER

Application No. ~~56295~~ Permit No. ~~42108~~.....
IN NAME OF

.....FRANZ DOLP.....

Surveyed NOV. 4, 19.81, by S.C. BROWN.....