

9-6803
74372

RECEIVED
DEC 5 1988
58062

T. 1S., R. 33E., W.M.

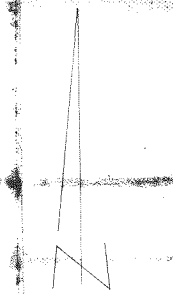
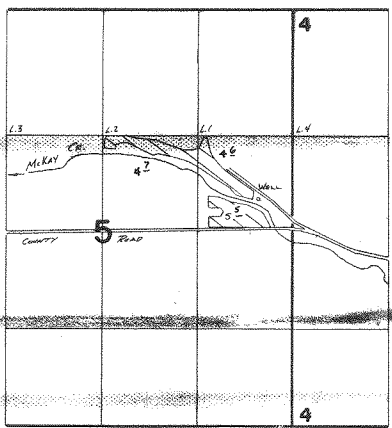

Well Loc: 2580'S ± 470'W. From NE Cor. Sec 5

SCALE 1" = 1320'

FINAL PROOF SURVEY UNDER

Application No. **G:7318**, Permit No. **G:6863**
IN NAME OF

..... **ROD THEIS**

Surveyed 2.25..... 1987., by H. Church.....