

T. IS., R. 39E., W.M.

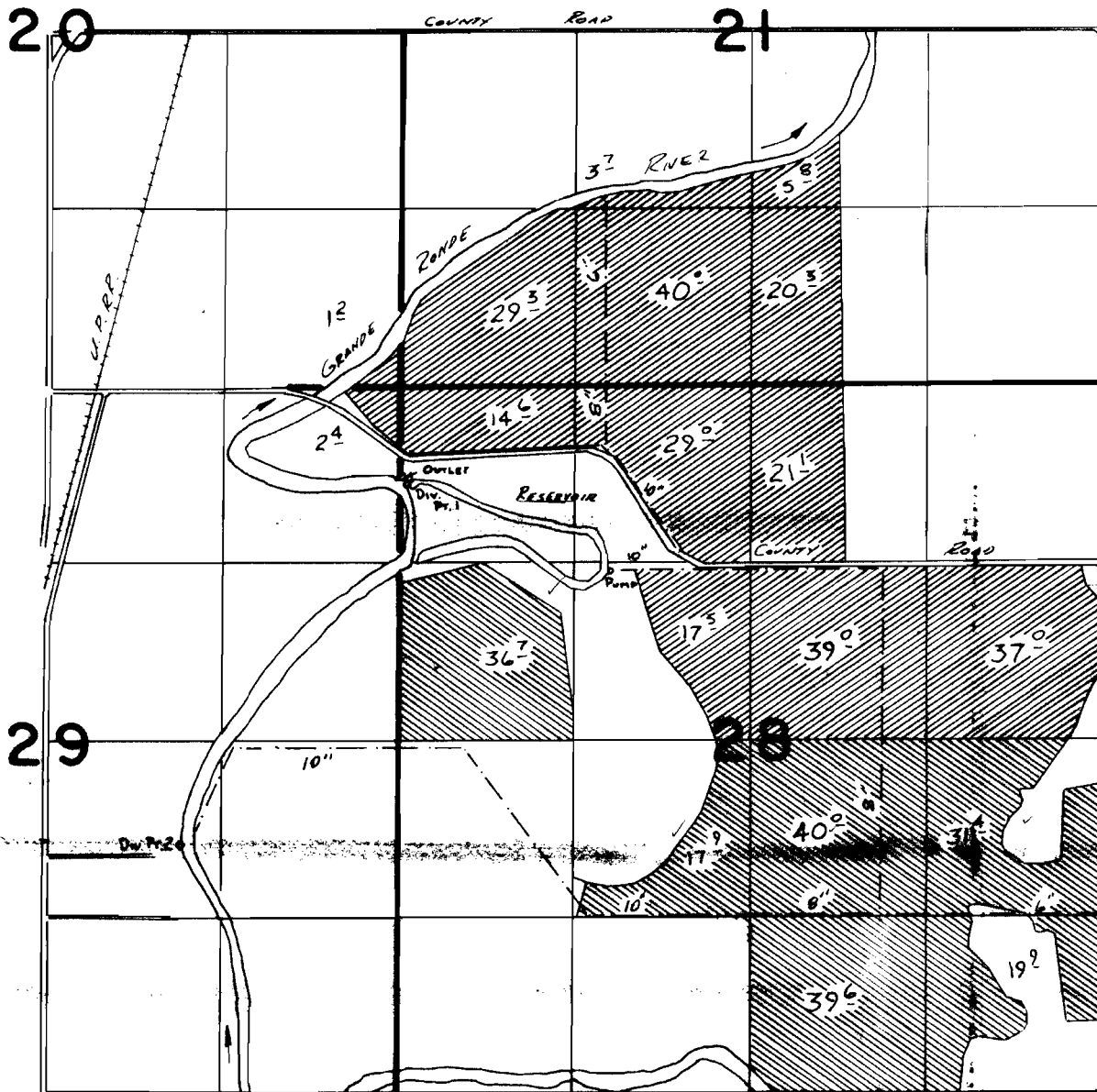

Div. Pt. 1 Loc: 720'S + 50'E. FROM NW COR. SEC 28
 Div. Pt. 2 Loc: 1850'N. + 1630'W. FROM SE COR. SEC 29
 PUMP Loc: 1380'S. + 1600'E FROM NW COR. SEC 28

FINAL PROOF SURVEY

UNDER

58785
58786

44320
44321

Application No. R. 58787 Permit No. R. 7844

IN NAME OF

WILLIAM B. FLORENCE HOWELL

Surveyed Aug. 23, 19.83., by *E. H. Church*

 44321
 44320