

# T. 1S., R. 39E., W.M.

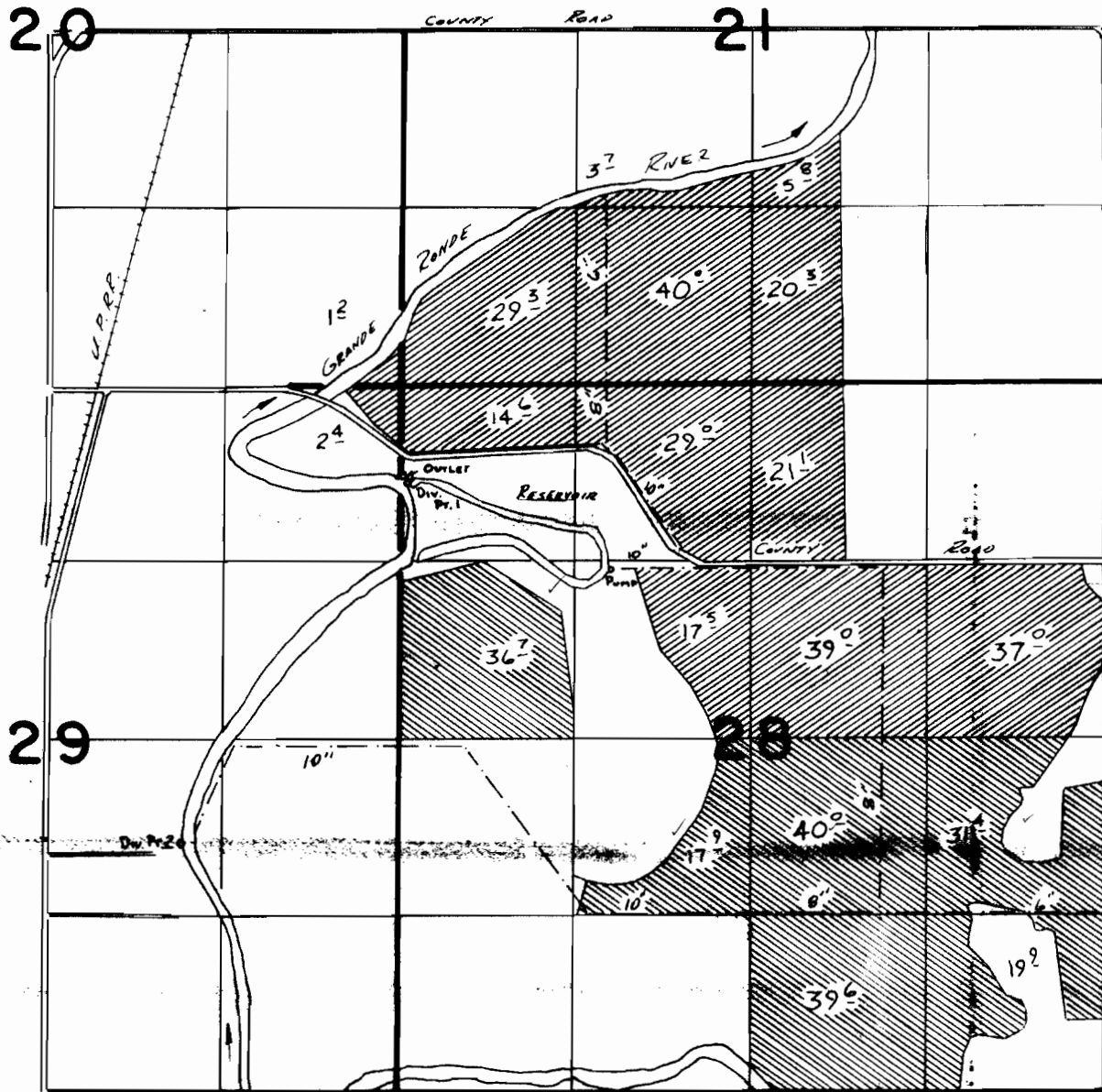

Div. Pt. 1 Loc: 720'S + 50'E. FROM NW COR. SEC 28  
 Div. Pt. 2 Loc: 1850'N. + 1630'W. FROM SE COR. SEC 29  
 PUMP Loc: 1380'S. + 1600'E FROM NW COR. SEC 28

## FINAL PROOF SURVEY

UNDER

58785  
58786

44320  
44321

Application No. **R-58787** Permit No. **R-7844**

IN NAME OF

**WILLIAM & FLORENCE HOWELL**

Surveyed Aug. 23, 1983, by *V. H. Church*

 44321  
 44320