

UNITED STATES  
DEPARTMENT OF THE INTERIOR  
BUREAU OF LAND MANAGEMENT

SECTION

24

# Oregon State Water Filings

TOWNSHIP 25 S, RANGE 46 E, W. M.

SHEEP RESERVOIR  
North

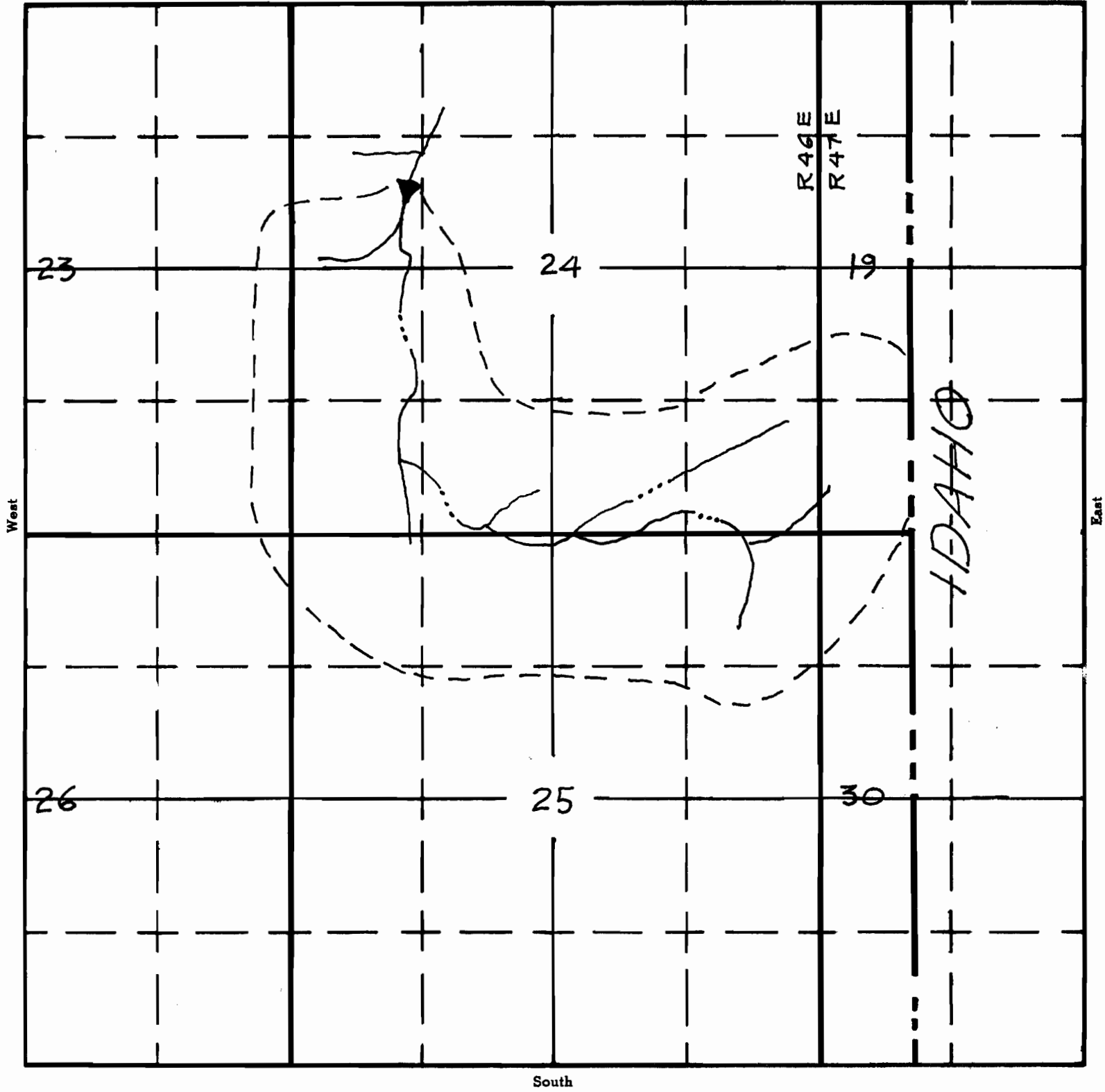

R 46 E  
R 47 E

IDAHO

APPLICATION No. R-40606

PERMIT No. P 5162