

T. 39 S., R. 19 E., W. M.

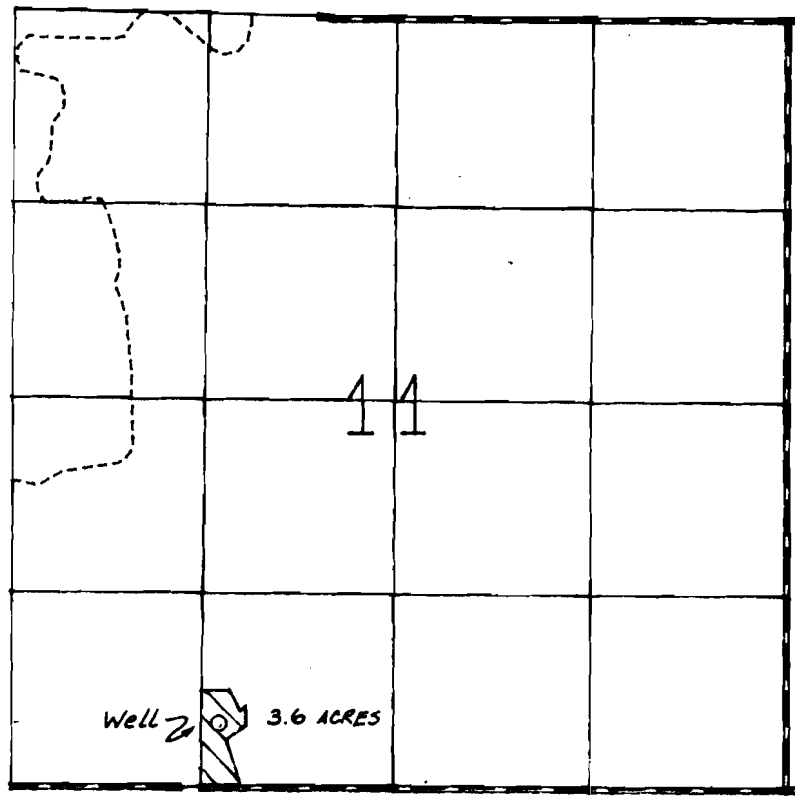

WELL LOCATED 440 FT. N AND 1430 FT. E. FROM SW COR. SEC. 11

SCALE: 1 = 1320

FINAL PROOF SURVEY

UNDER

Application No. 6-9454 Permit No. 6-8811

IN NAME OF

RICHARD L. & COLLEEN S. HARLOW

Surveyed Oct. 17, 1987 By M. J. MATTICK