

T. 9S., R. 4W., W.M.

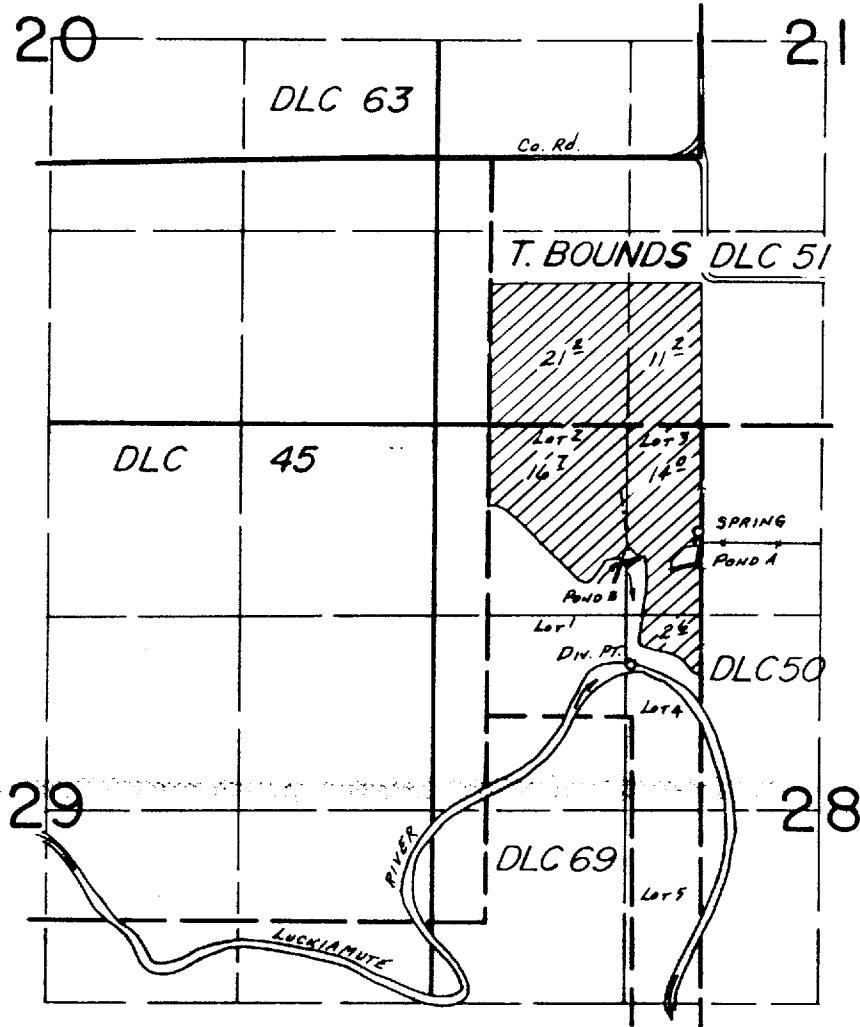

*Div. Pts. Loc.: SPRING- 720' S. 1800' E.; Pond "A"- 940' S. 1780' E.;
CANYON CREEK & POND "B"- 930' S. 1340' E.; RIVER- 1640' S. &
1350' E., ALL FROM NW COR. SEC. 28.*

FINAL PROOF SURVEY
UNDER

R-52126 R-6415
Application No. 51950 Permit No. 40286.....
IN NAME OF

.....MARSHALL O. BUTLER.....

Surveyed NOV. 5... 1981.., by S.C. BROWN.....