

# T.17S., R.11W., WM.

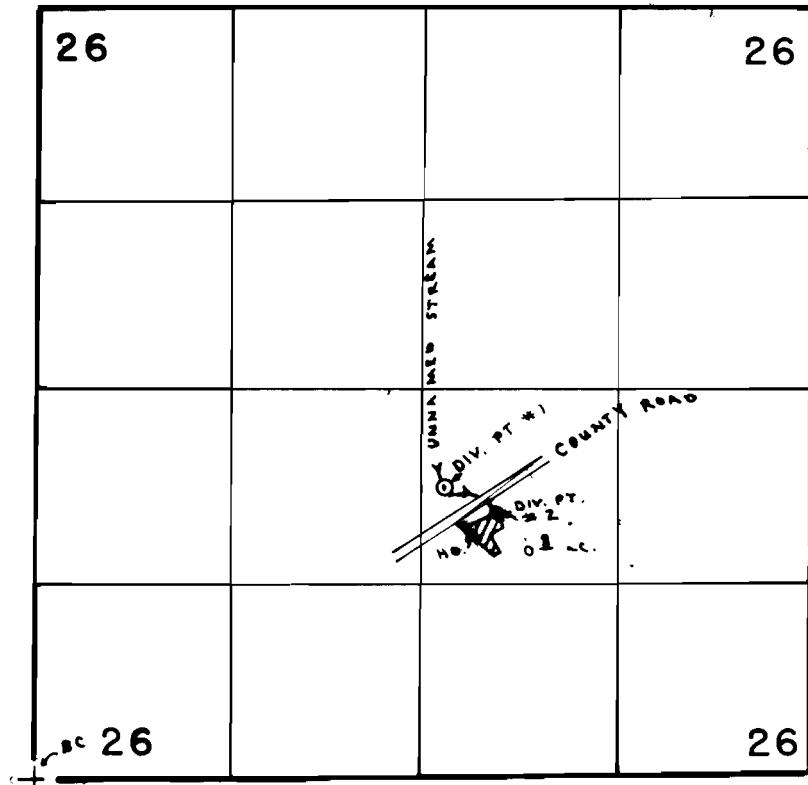

DIV. PT. LOC. # 1 - 1980' N. & 2800' E. OF SW. COR. SEC. 26  
2 - 1800' N. & 3150' E. OF SW. COR. SEC. 26

## FINAL PROOF SURVEY UNDER

Application No. 59339 Permit No. 44656  
IN NAME OF

CHESTER D. EMBREE

Surveyed OCT. 31 1983, by PAGTER, P.