

T.4S. R.4W. W.M.

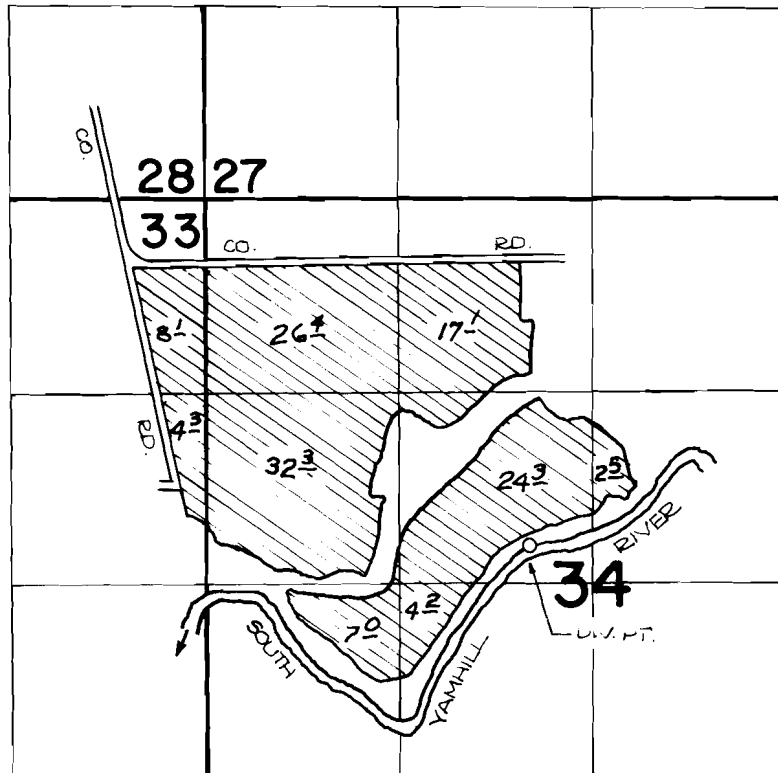

THE DIVERSION POINT IS LOCATED 2390' S. AND 2220' E.
FROM THE N.W. CORNER OF SECTION 34.

FINAL PROOF SURVEY UNDER

Application No. 55599. Permit No. 41663.....
IN NAME OF

.....WILLIAM T. BOYER.....

Surveyed SEPT. 30, 1983, by P. Pagter.....