

T.9S.,R.4W.,W.M.

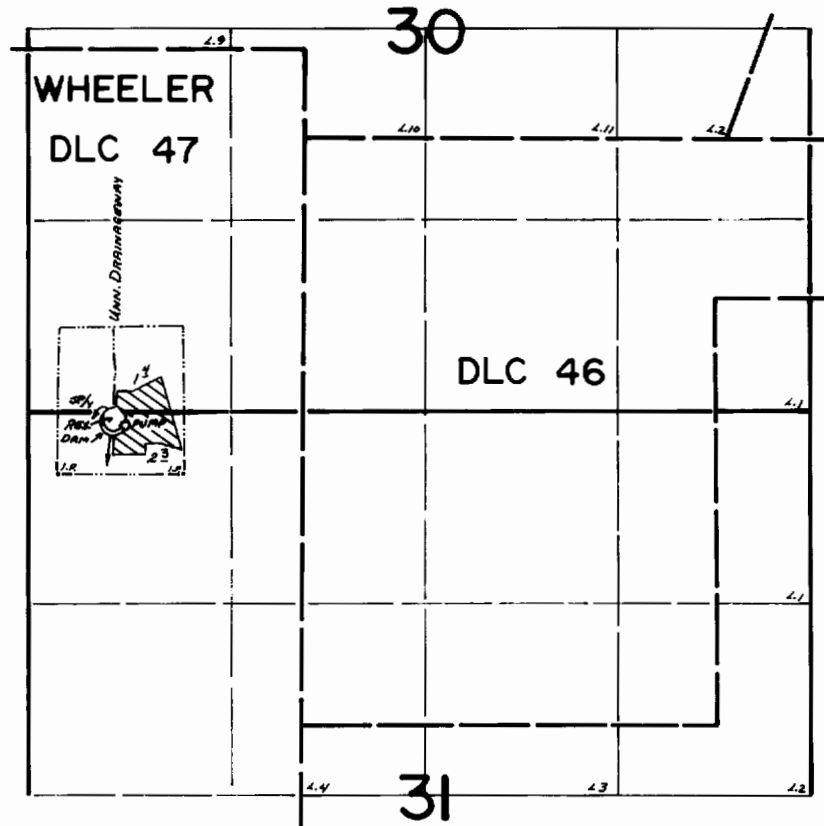

DAM LOCATION: 160 Ft. S. and 580 Ft. E. from the NW Cor. Sec. 31

FINAL PROOF SURVEY UNDER

R-55398 R-6615
Application No. 55399 Permit No. 41807
IN NAME OF

MERLIN SCHWEITZER

Surveyed May 2, 1981, by S. C. BROWN