

T. 1 S., R. 4 E., W. M.

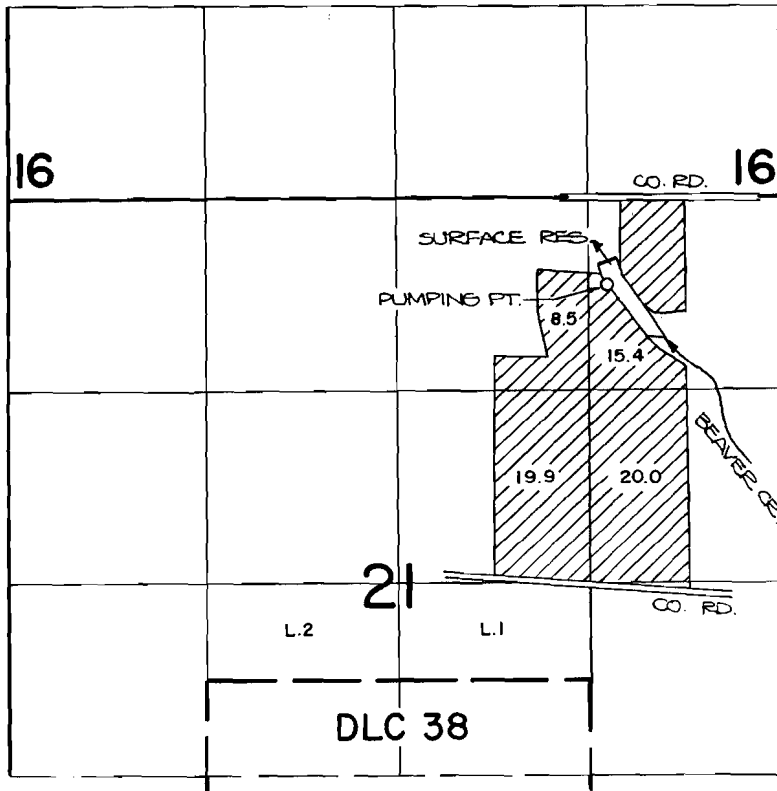

DAM LOCATION: 450 FT. S. AND 1200 FT. E. FROM THE N.E. CORNER OF SECTION 21.

FINAL PROOF SURVEY
UNDER

R-56139 R-6630
Application No. 56140 Permit No. 41956
IN NAME OF

..... RICHARD SURFACE

Surveyed MAY 1, 1984, by *P. Patten*



SCALE: 4" = 1 MILE