

T.4S. R.5W. W.M.

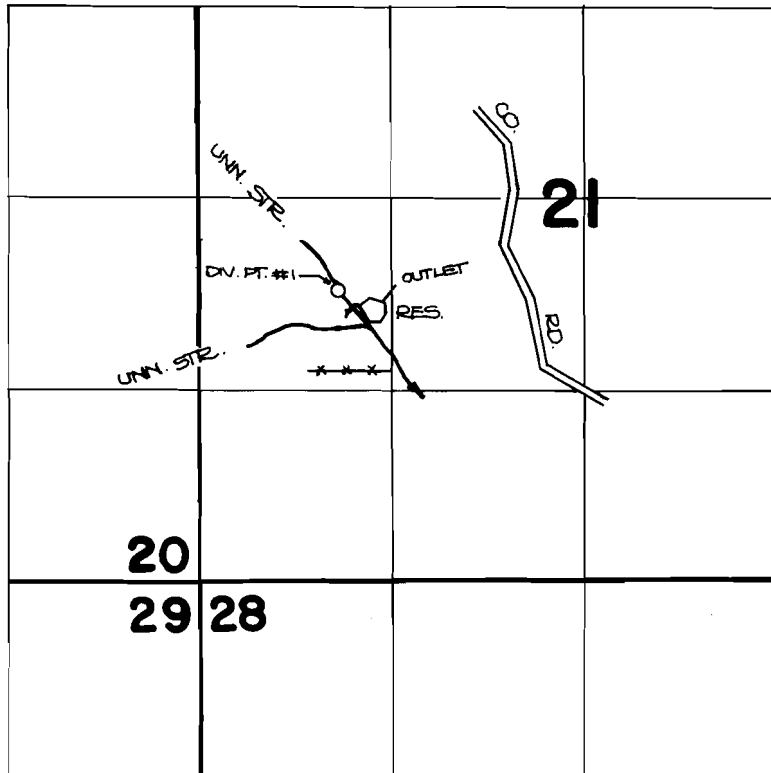

DIVERSION POINT #1 IS LOCATED 1990' N. AND 970' E.,
FROM THE S.W. CORNER OF SECTION 21.

FINAL PROOF SURVEY
UNDER

R-56886 R-6888
Application No. ~~5.6.8.8.7.~~ Permit No. ~~4.2.7.6.8.~~...
IN NAME OF

.....**EMIL FEIBEL**.....

Surveyed ~~OCT. 4.~~ 19.83, by ~~P. Patten~~.....