

T.4S. R.5W. W.M.

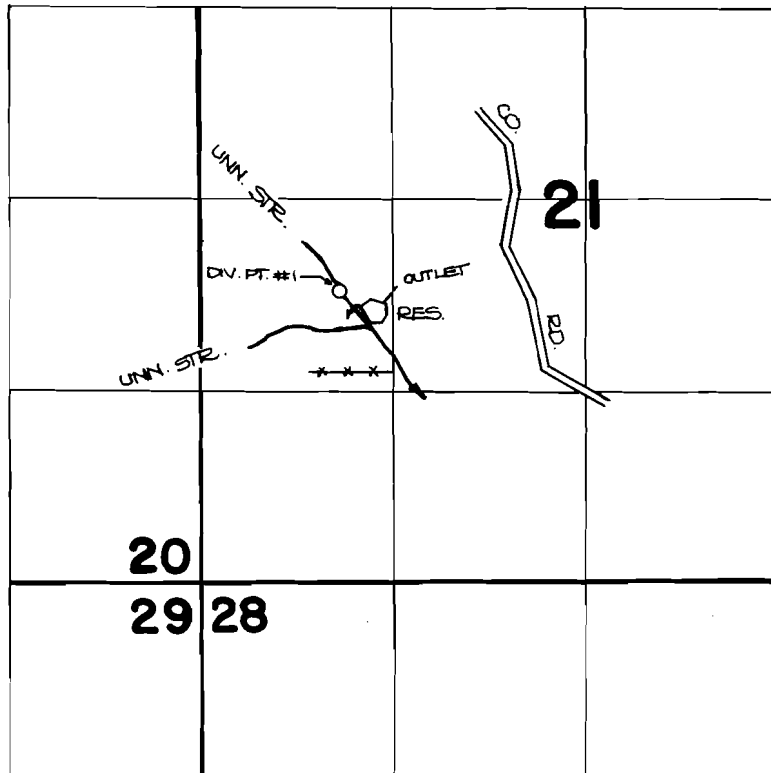

DIVERSION POINT #1 IS LOCATED 1990' N. AND 970' E.,
FROM THE S.W. CORNER OF SECTION 21.

FINAL PROOF SURVEY
UNDER

R-56886 R-6888
Application No. 56887. Permit No. 42768....
IN NAME OF

.....**EMIL FEIBEL**.....

Surveyed OCT. 4, 1983, by P. Patten.....