

T. 1S., R. 33E., W. M.

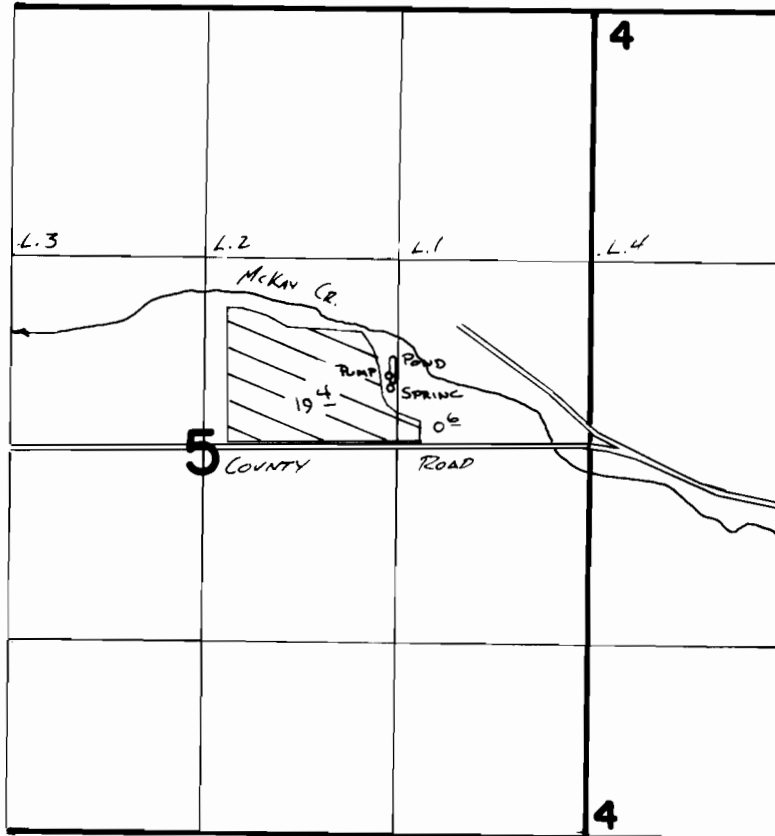

SCALE 1" = 1320'

POND: 2500'S. & 1370'W. FROM NE COR. SEC 5

FINAL PROOF SURVEY UNDER

Application No. **58666** Permit No. **44219**....
IN NAME OF

.....**G. KENT HETTINGA**.....

Surveyed ..**6-29**..... 19**87**., by *V.L. Church*.....