

T.4S.,R.1E.,W.M.

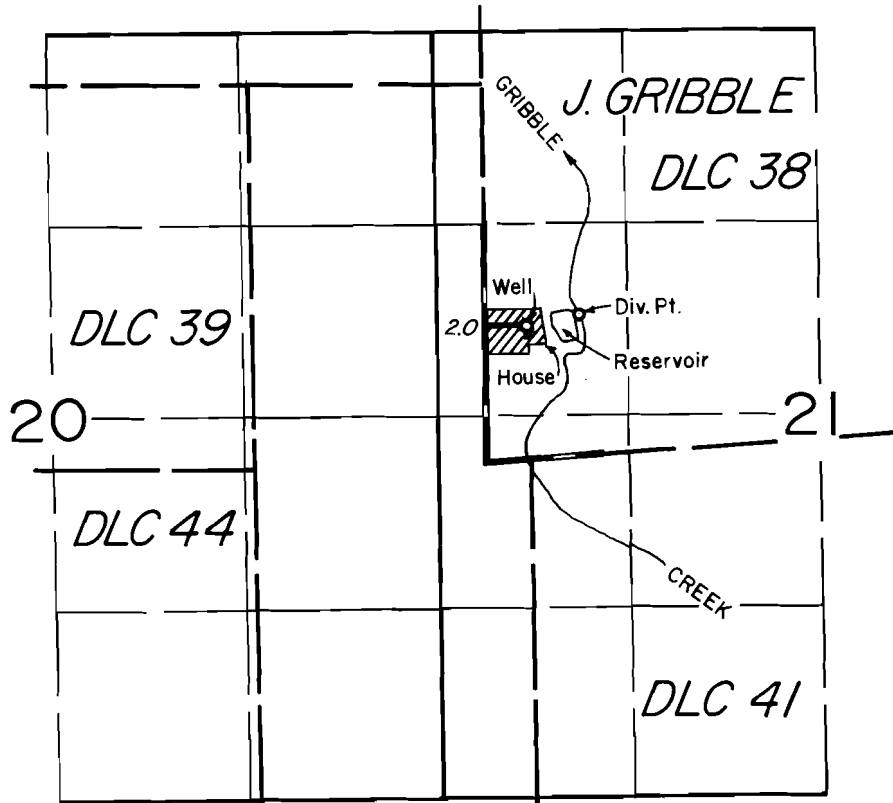

Points of Appropriation Located: Well - 950' N. & 280' E.; Creek - 1020' N. & 650' E.; both from the SW corner DLC 38

FINAL PROOF SURVEY

UNDER

G-8380
R-56432

G-7561
R-6661

Application No. 56433 Permit No. 42013

IN NAME OF

WAYNE FISK

Surveyed AUG. 14, 1981, by *J. Brown*