

T.26 S., R.6 W., W.M.

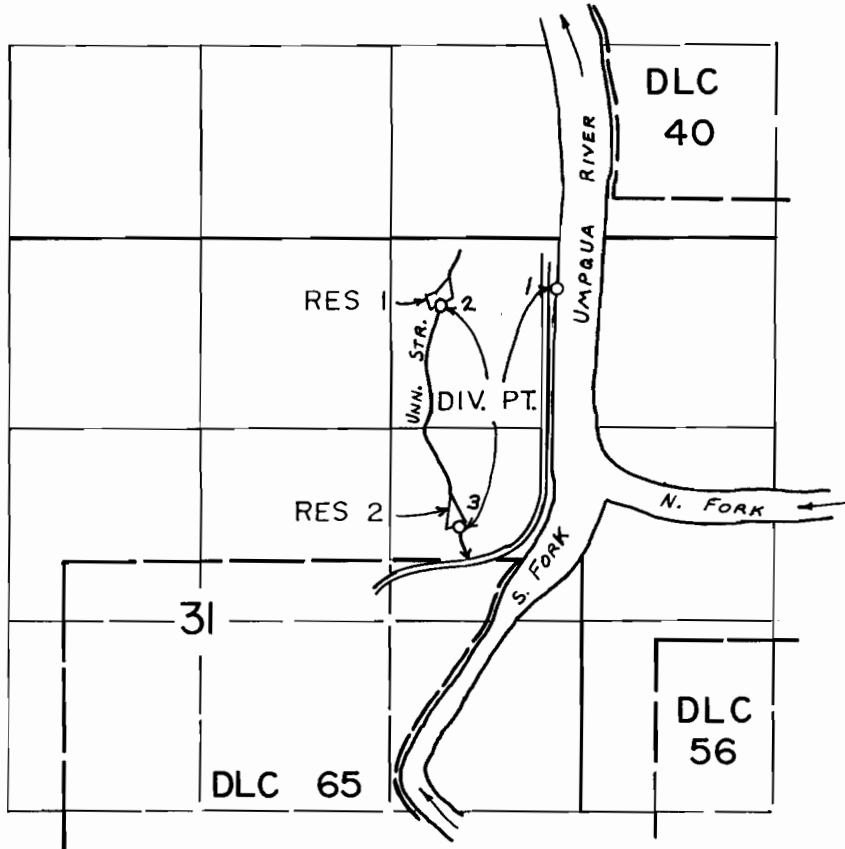

DIV. PT. LOCATIONS:

- 1- 2300' N., 175' W.
- 2- 2170' N., 980' W.
- 3- 650' N., 850' W.

ALL FROM E. 1/4 COR.
SEC. 31

SCALE: 4" = 1 mile

FINAL PROOF SURVEY
UNDER

R-63260

R-8411

Application No. 63261 Permit No. 46713.....

IN NAME OF

MARK STERNER

Surveyed NOV 18, 19 83, by L. Cashion.....
DEC 19