

T.4&5S.,R.3W.,W.M.

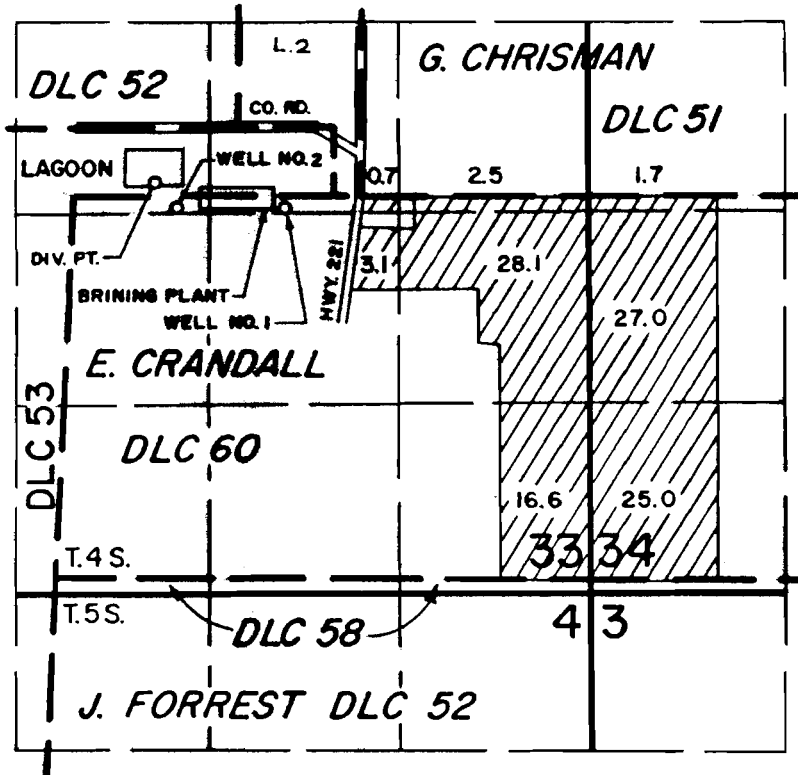

THE DIVERSION POINT IS LOCATED 100 FT. N. AND 550 FT. E.;
 WELL NO. 1 IS LOCATED 60 FT. S. AND 1440 FT. E.;
 WELL NO. 2 IS LOCATED 60 FT. S. AND 700 FT. E;
 ALL FROM THE N.W. CORNER OF E. CRANDALL DLC 60.

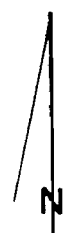

SCALE: 4" = 1 MILE

FINAL PROOF SURVEY UNDER

R-61876 R-8288
 61877 45904
 Application No. ~~G-7135~~ Permit No. ~~G-6697~~.....
 IN NAME OF

GRAY & COMPANY

Surveyed APR. 27. 1984., by P. Paster