

# T. 2 S., R. 4 W. WM.

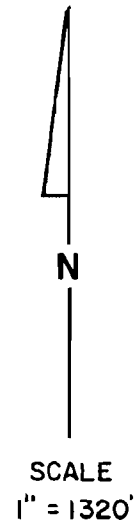
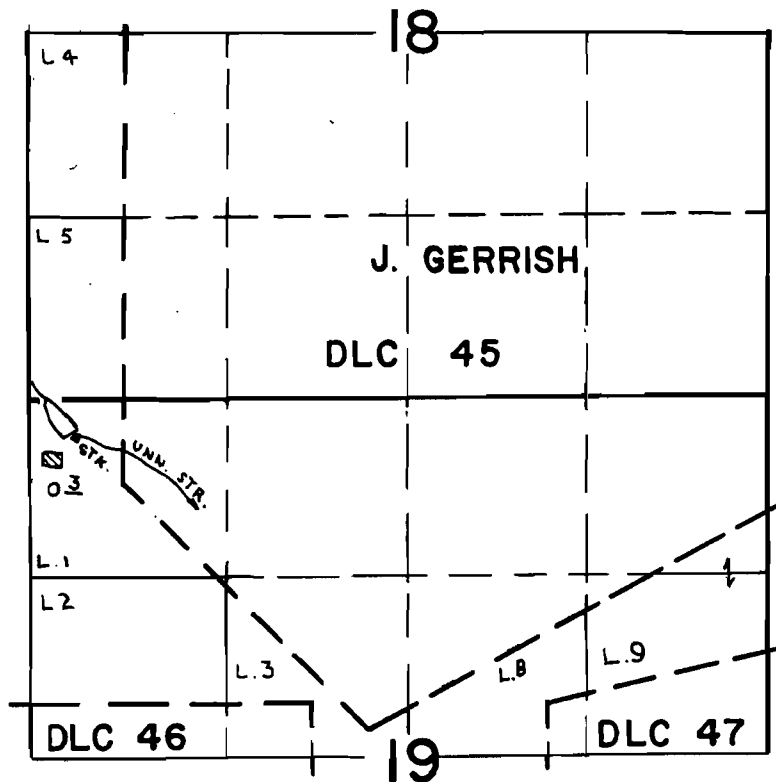

DIV. PT. LOC. 370' N. & 350' W. OF SW COR. DLC 45

## FINAL PROOF SURVEY UNDER

R 61012                      R 8224  
Application No. 61013 Permit No. 45450.....  
IN NAME OF

KENNETH B. MOORE.....

Surveyed AUG 23, 1984, by P. PAGTER.....