

RECEIVED

AUG 24 1979

WATER RESOURCES DEPT
SALEM, OREGON

T.6S.,R.10W.,W.M.

Application No. 59256
Permit No. 44936

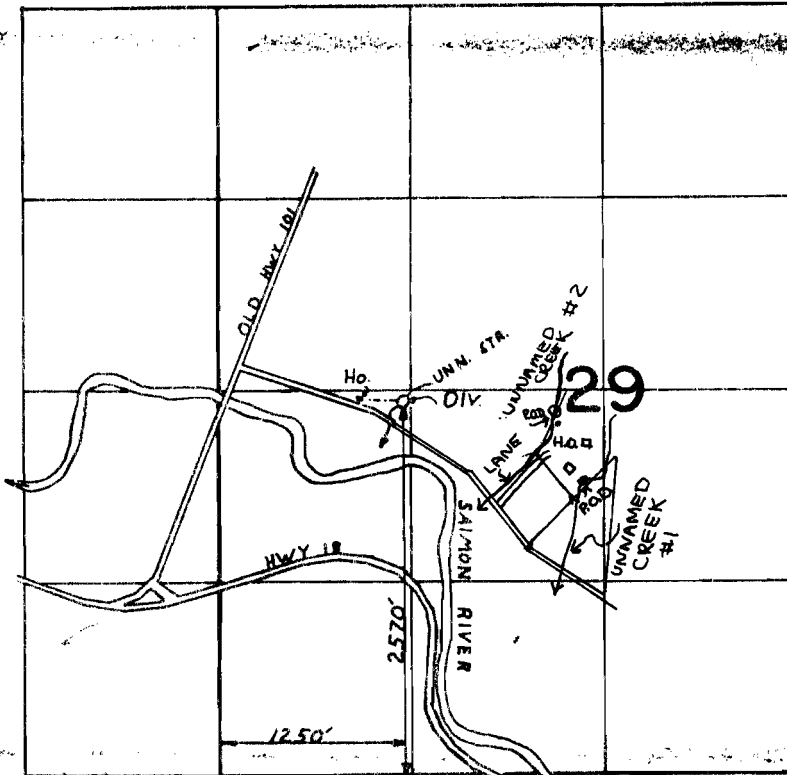

- #1 P.O.D. 625' S. & 125' W. FROM THE CENTER OF SECTION 29 T.6S.R.10W.W.M.
- #2 P.O.D. 150' S. & 325' W. FROM THE CENTER OF SECTION 29 T.6S.R.10W.W.M.

~~FINAL PROOF SURVEY~~
~~UNDER~~

~~Application No. 50288 Permit No. 37377~~
~~IN NAME OF~~

~~GAYTON R. & DORIS E. PHELPS~~

~~Surveyed JUNE 29, 1976, by C.R. KING~~

map
Prepared

Mike Lead