

T. 26S., R. 3 W., W.M.

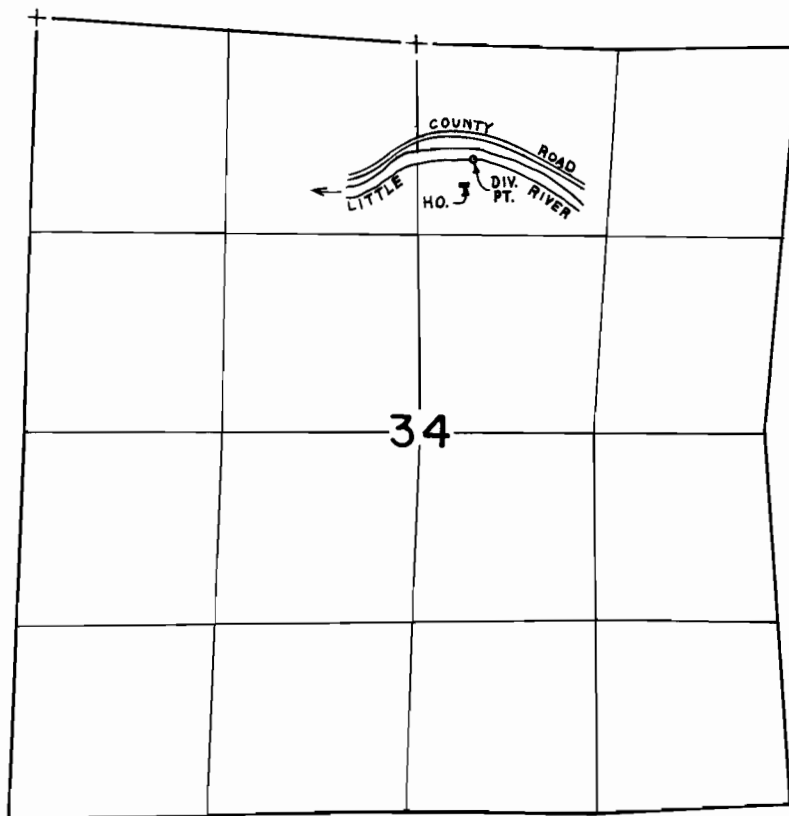

DIV. PT. LOCATED 790'S. & 380'E. FROM N. 1/4 COR. SEC. 34

SCALE: 4" = 1 mile

FINAL PROOF SURVEY UNDER

Application No. 65031... Permit No. 47783...
IN NAME OF

JAMES E. ALLEN

Surveyed JUL. 25, 1984, by L. CASHION...