

T. 2N., R. 33E., W.M.

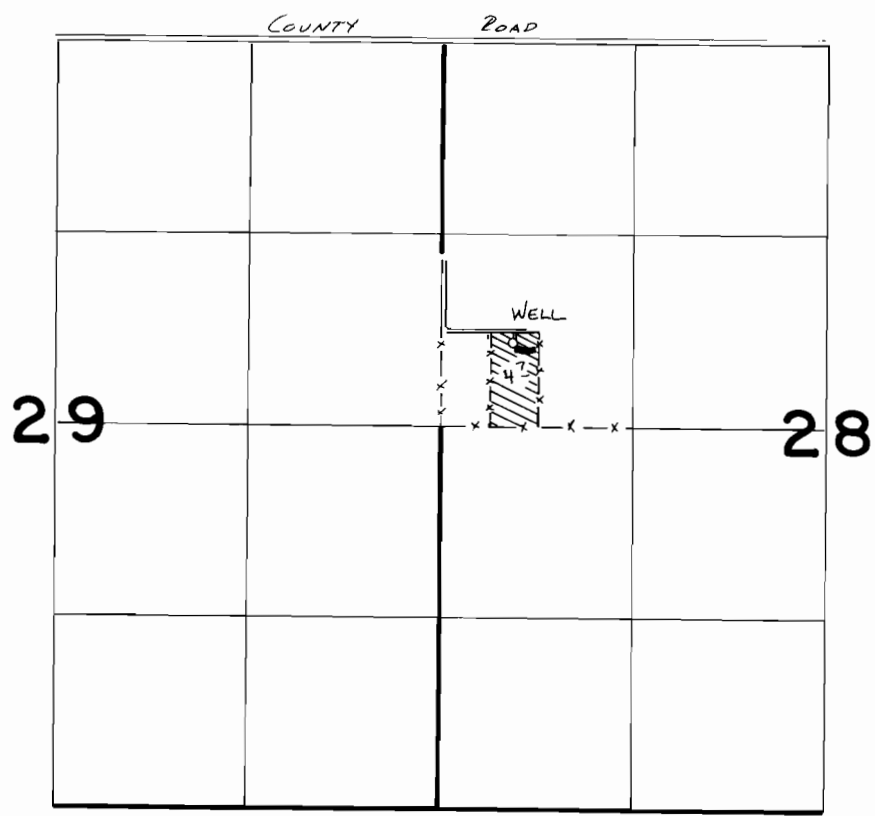

WELL LOC: 580' N. & 490' E. FROM W1/4 COR SEC 28

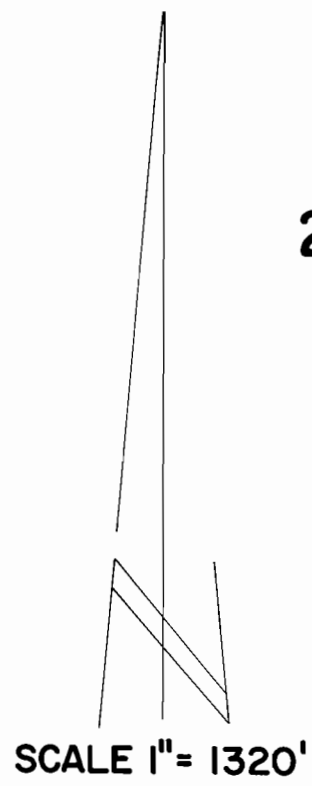

FINAL PROOF SURVEY
UNDER

Application No. **G:11522** Permit No. **G:10606**
IN NAME OF

.....**DAVID L. AND JAN M. PATTON**.....

Surveyed ..**2-17**..... **1987**., by **V.L. Church**.....