

T.1S.,R.3W.,W.M.

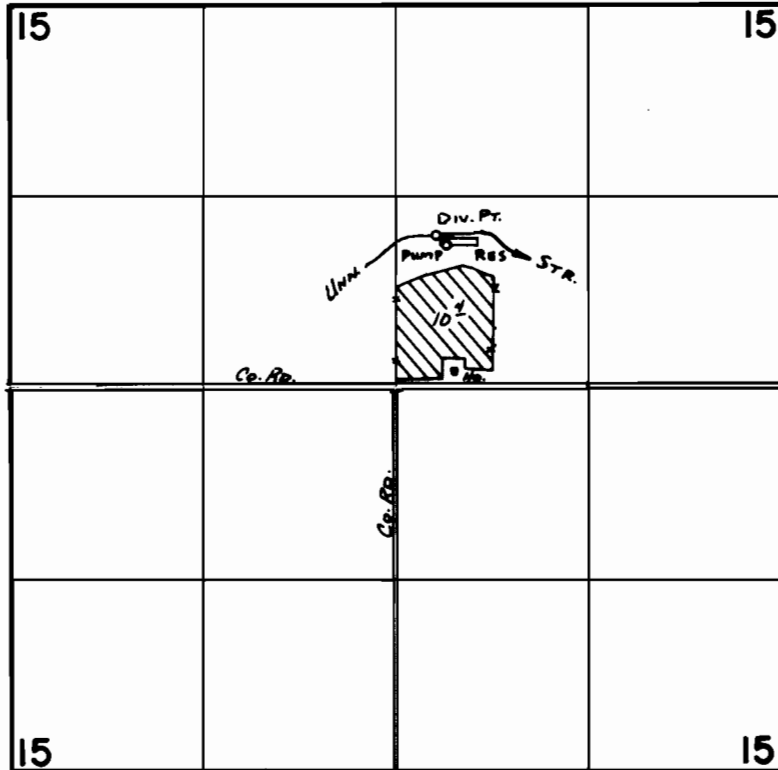

Str. Div. - 1030 ft. N. & 280 ft. E. > Both from Center of Section 15
Dam Div. - 990 ft. N & 560 ft. E

SCALE: 1" = 1320'

FINAL PROOF SURVEY UNDER

R-56841 R-7342
Application No. .56842. Permit No. ...43076....
IN NAME OF

.....WAYNE K. RUSSELL.....

Surveyed Nov. 4, 1983, by L. M. TOLL.....