

T.29S., R.4&5W., W.M.

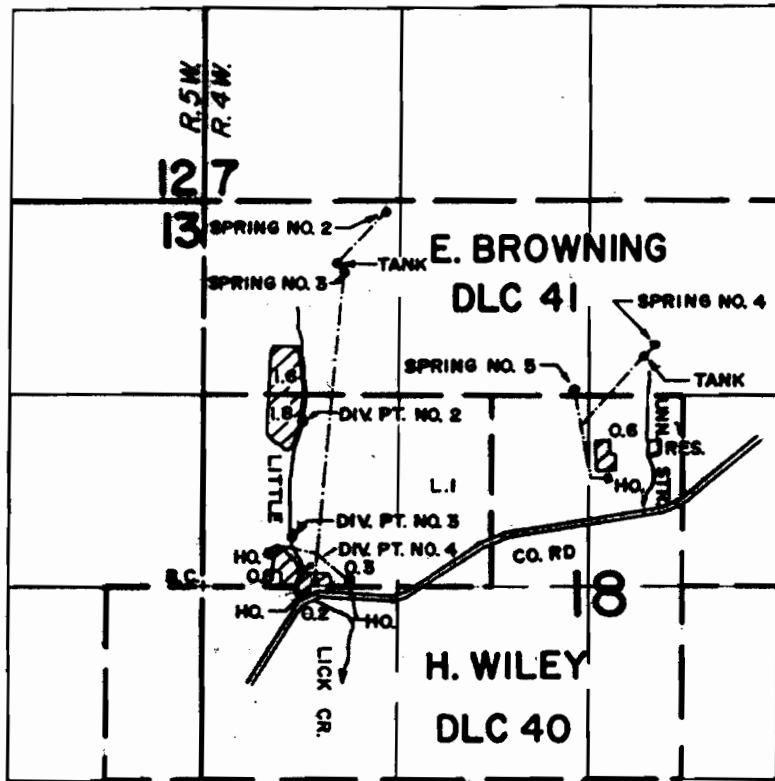

DIV. PT. #2 LOC.: 500 FT. S. AND 660 FT. E.; DIV. PT. #3 LOC.: 2300 FT. S. AND 620 FT. E.; DIV. PT. #4 LOC.: 2520 FT. S. AND 660 FT. E.;
 SPRING #2 LOC.: 60 FT. S. AND 1240 FT. E.; SPRING #3 LOC.: 480 FT. S. AND 960 FT. E.; SPRING #4 LOC.: 960 FT. S. AND 310 FT. E.;
 SPRING #5 LOC.: 1290 FT. S. AND 2360 FT. E.; STREAM & RESERVOIR - 1750 FT. S. AND 3050 FT. E.; ALL FROM NW CORNER SECTION 18.

FINAL PROOF SURVEY
 UNDER

R-58438 R-7816
 Application No. 58439.. Permit No. 44075.....
 IN NAME OF

LAVINA P. ARROWOOD

Surveyed MAY. 14., 1984., by J.L. CASHION.....

SCALE: 4" = 1 MILE