

T.5&6S.,R.1E.,W.M.

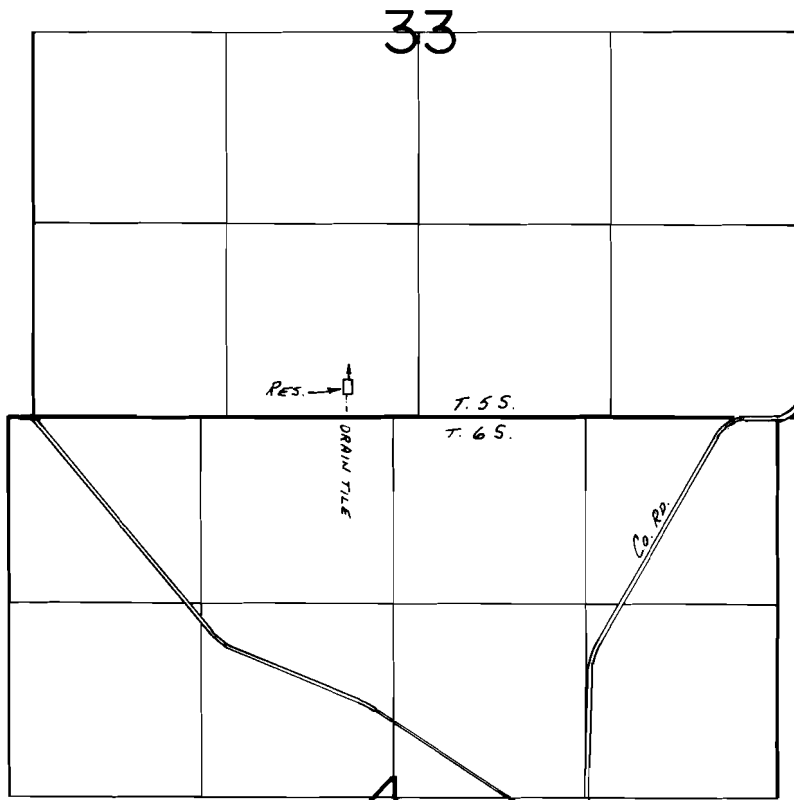

Div. Pt. Loc. 250' N. & 2160' E. FROM SW COR. SEC. 33.

SCALE: 1" = 1320'

FINAL PROOF SURVEY
UNDER

R-58797 R-7838
Application No. 58798... Permit No. 44303.....
IN NAME OF

.....RALPH JOHN OSTER.....

Surveyed Aug. 8.... 19.84, by J.R. WOODROOF...