

T.17S.,R.3W.,W.M.

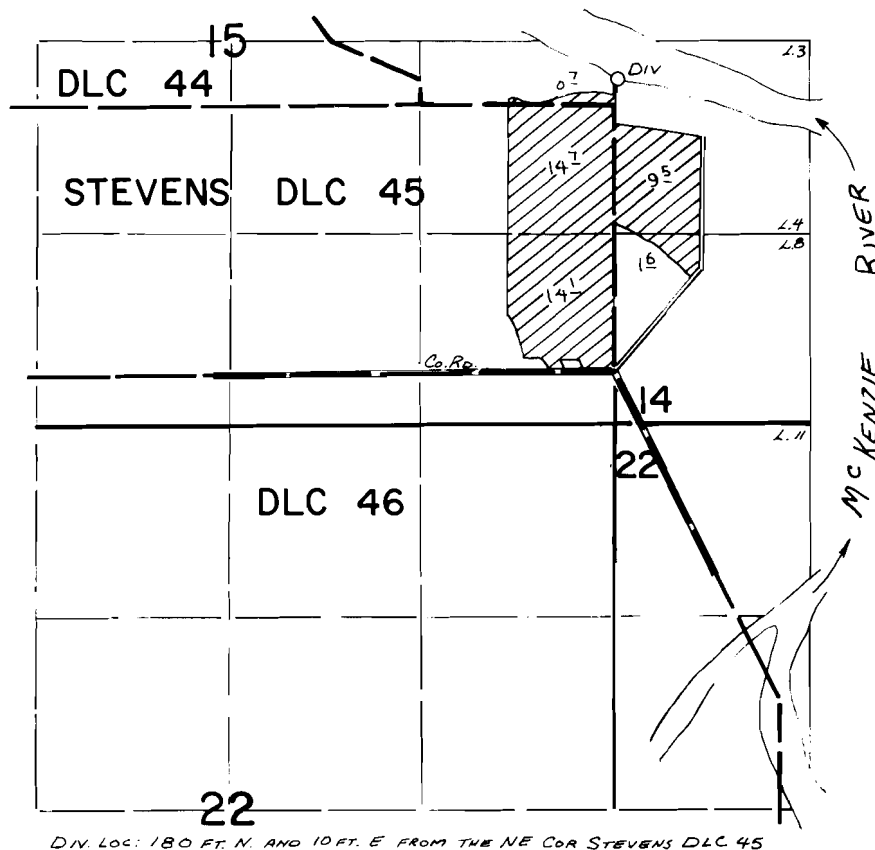

DIV. LOC: 180 FT. N. AND 10 FT. E FROM THE NE COR STEVENS DLC 45

FINAL PROOF SURVEY
UNDER

Application No. 55441... Permit No. 41819.....
IN NAME OF

.....**HAROLD E. RICE**.....

Surveyed May...6... 1982., by L.M. TOLL.....