

T. 15., R. 38E., W.M.

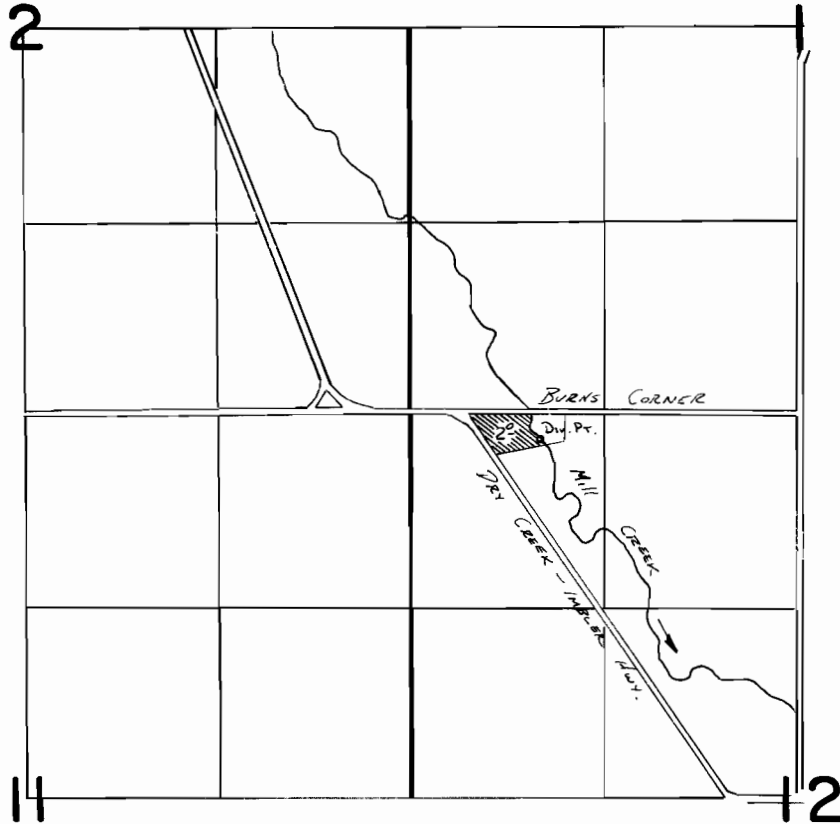

Div. Pt. Loc: 190' S. & 900' E. FROM NW COR SEC 12

FINAL PROOF SURVEY
UNDER

Application No. **55469** Permit No. **41831**.....
IN NAME OF

.....**BERYL W. PUGH**.....

Surveyed 8-22..... 1983., by V.L. Church.....