

T.3S., R.5W., W.M.

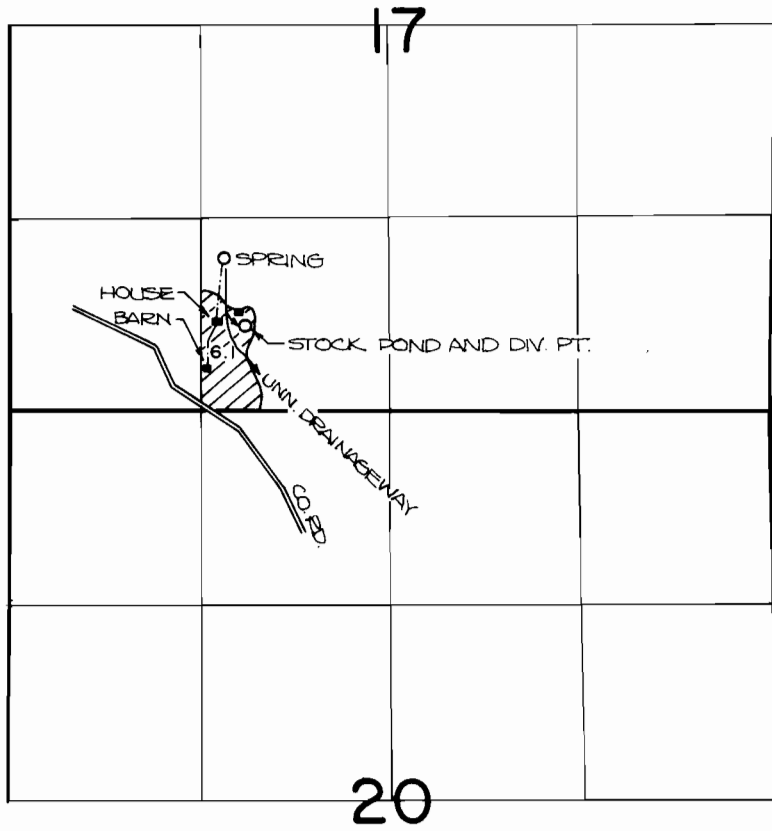

SPRING LOCATION: 1050 FT. N. AND 1460 FT. E.; DIV. PT. LOCATION: 580 FT. N. AND 1610 FT. E.; BOTH FROM THE S.W. CORNER OF SECTION 17.

FINAL PROOF SURVEY UNDER



Application No. 56186... Permit No. 42242.....
IN NAME OF

SCALE: 4" = 1 MILE

..... LEROY & BETHEL WHITE

Surveyed JULY 23, 1984., by *P. Pagter*.....