

T. 14 S., R. 5 W., W. M.

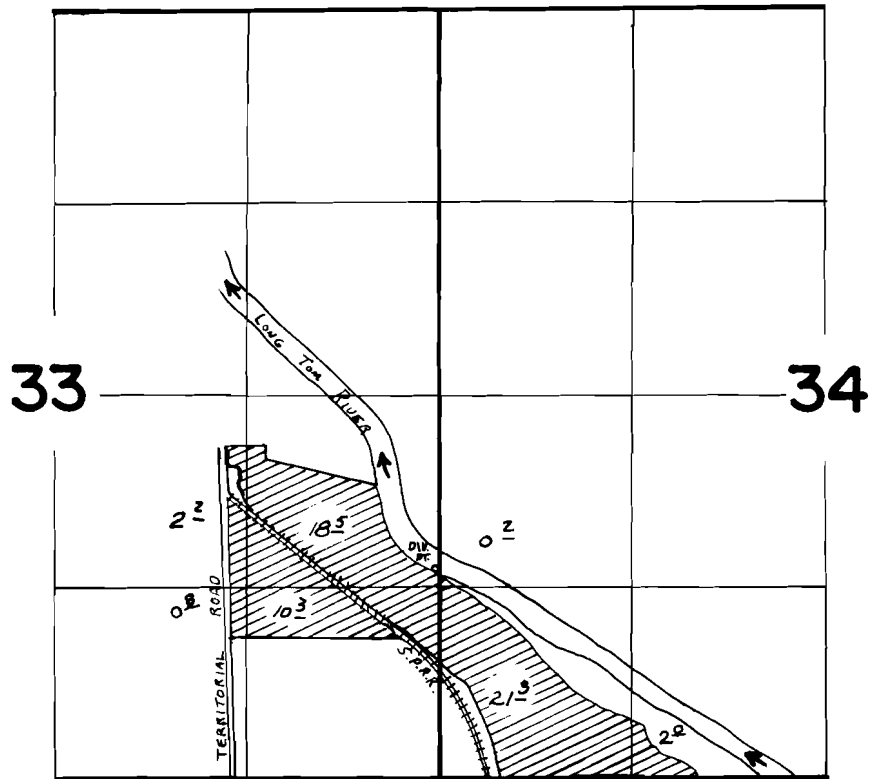

Div. Pt. Loc.: 1440' N. & 30' W. from the SE Cor. Sec. 33

FINAL PROOF SURVEY UNDER

Application No. 55554. Permit No. 42524.....
IN NAME OF

ALLEN. R. WISER

Surveyed JULY 7, 1983, by L. TOLL.....